

Single piece copper body reduces potential leak paths by 75% over conventional ball valves.

Superior HVACR introduces an innovative copper spun ball valve design that meets the highest standards of performance and quality expected in the industry. Using precision formed bodies made from a singular copper tube, the Uni-Body design eliminates potential leak paths that are associated with forged and cast body valves. Solder joints needed for connections between the tubes and bodies in traditional valves are eliminated, as is the need for any high temperature body welding. The elimination of excessive heat to the valve during the manufacturing process assures valve seals will not be damaged and will provide long lasting reliable performance. An internally loaded ball stem, with pin stops guarantees safety, as well as a visual indication of ball position without the need for internal stops that can easily break and contaminate a system. The Superior CS/CSA Copper-Spun series of valves eliminates unnecessary leak paths for a more hermetic approach to system design.

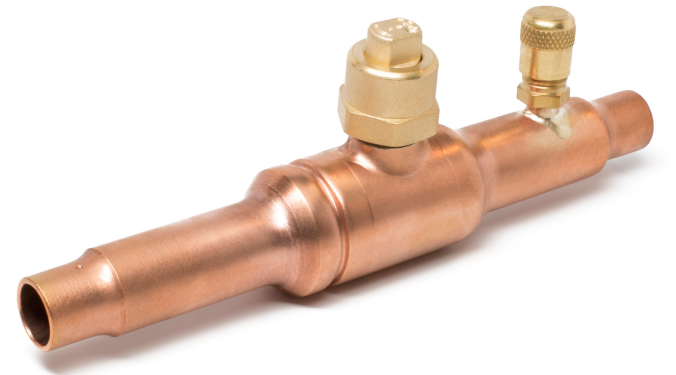

- Continuous operating temperature (COT): -40°F to 300°F, (-40°C to 149°C)
- Design pressure/ Maximum abnormal pressure: 700 psig, 48 bar
- UL® and cUL Listed, Conforms to PED 2014/68/EU
- Patent Pending Uni-Body design
- Solid copper body assures easy connection and quick installation time
- Full port construction to eliminate pressure drop
- Bi-directional flow
- Internally loaded stem assures safety
- 1/4 Turn operation for easy on/off operation
- External pin stop provides visible indication of ball position and cannot break off in system
- Two-piece cap for easy operation without need for removal
- Available with access ports in sizes 1/4" to 7/8"
- Contact factory or visit website for compatibility with CFC, HCFC, HFC and HFO refrigerants and oils.



CS Series

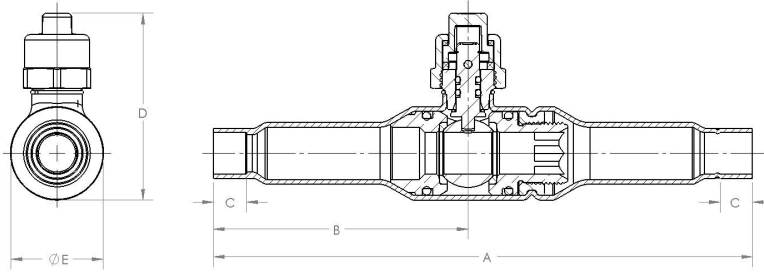

Part Number	Size (ODS)	Ball Port Diameter	Dimensions					Max Width	Cv	DP/MAP	UPC	Weight (lbs.)
			A	B Min	C	D	E					
Without Access Fitting												
686CS-4	1/4	1/2	6.50	3.07	0.26	2.25	1.13	1.13	700	685768439714	0.64	
686CS-6	3/8	1/2	6.50	3.07	0.34	2.25	1.13	1.13	700	685768439721	0.64	
686CS-8	1/2	1/2	6.50	3.07	0.38	2.25	1.13	1.13	700	685768439462	0.65	
686CS-10	5/8	1/2	6.50	3.07	0.51	2.25	1.13	1.13	700	685768439738	0.64	
687CS-12	*	3/4	7.40	3.70	0.63	2.62	1.38	1.38	700			
687CS-14	*	7/8	7.40	3.70	0.76	2.62	1.38	1.38	700		1.18	

* Consult factory for details.

CSA Series

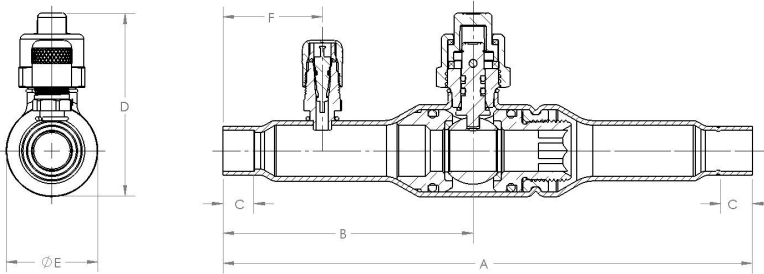

Part Number	Size (ODS)	Ball Port Diameter	Dimensions						Max Width	Cv	DP/MAP	UPC	Weight (lbs.)
			A	B Min	C	D	E	F					
With Access Fitting													
686CSA-4	1/4	1/2	6.50	3.07	0.26	2.25	1.13	1.22	1.13	700	685768439745	0.68	
686CSA-6	3/8	1/2	6.50	3.07	0.31	2.25	1.13	1.22	1.13	700	685768439752	0.68	
686CSA-8	1/2	1/2	6.50	3.07	0.38	2.25	1.13	1.22	1.13	700	685768439769	0.68	
686CSA-10	5/8	1/2	6.50	3.07	0.51	2.25	1.13	1.22	1.13	700	685768439776	0.68	
687CSA-12	*	3/4	7.40	3.70	0.63	2.62	1.38	1.50	1.38	700			
687CSA-14	*	7/8	7.40	3.70	0.76	2.62	1.38	1.50	1.38	700		1.18	

* Consult factory for details.