

BrüTank™ 55qt

Tips + Tricks

Ice Retention

Start with a chilled cooler and chilled beverages

If the beverages you are putting into the BrÜTank start out warm, a significant amount of ice will be wasted cooling the cooler itself. Preload your cooler a few hours prior to use with a sacrificial bag of ice to cool it down or store it in a cool place before loading it up.

Ice temperatures vary slightly

Warm ice (around 32°F) is typically wet or dripping and won't last long. Ice that is colder than freezing point is relatively dry and will last substantially longer.

Air and sunlight are the enemy

Large areas of air inside your cooler will accelerate ice melt as the ice is consumed with having to cool the air, instead of your contents. If you do need to leave space in your cooler, they are best filled with extra ice or beverages. Keeping the cooler out of direct sunlight will also maximize ice retention.

Don't drain the water

Do not empty the cold water from the melted ice. The water helps to insulate the remaining ice.

Rock salt is your friend

Using rock salt will super-chill your contents. Simply sprinkle rock salt on top of the ice, close your cooler and enjoy extra cold drinks.

How to Insert the Tank

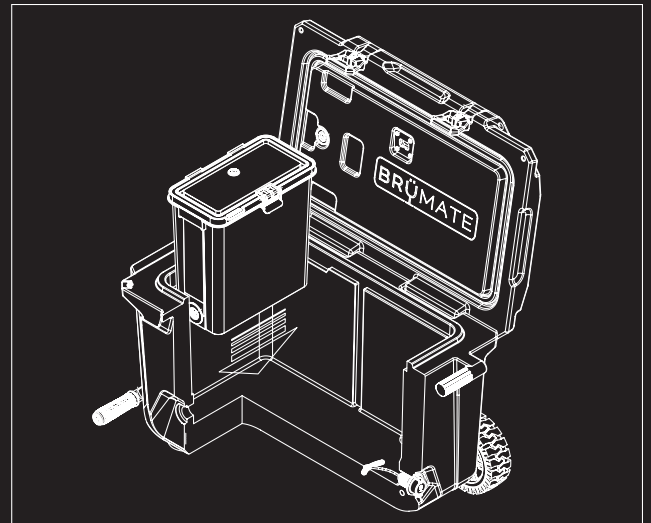

Slide the tank into the cooler and ensure it is seated securely.

ProTip: You can also use the cooler without the tank to increase ice capacity.

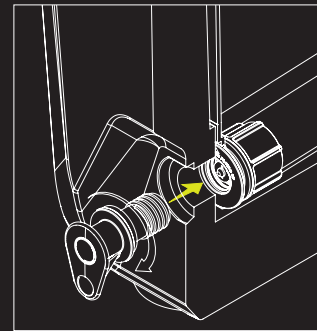

- 01 Once the tank has been installed, insert the tap from the outside and hand-tighten until the tap is facing vertically. Do not over-tighten.
- 02 To use the tap, press the button, and it will activate the internal tap allowing liquid to flow freely. When not in use, use the included spout cover to keep it clean.
- 03 When removing the tank simply unscrew the tap and lift the tank out of the cooler and witness the magic of our self-tapping tank at work.

BrüTank™ 55qt

Tips + Tricks

How to Drain the Cooler

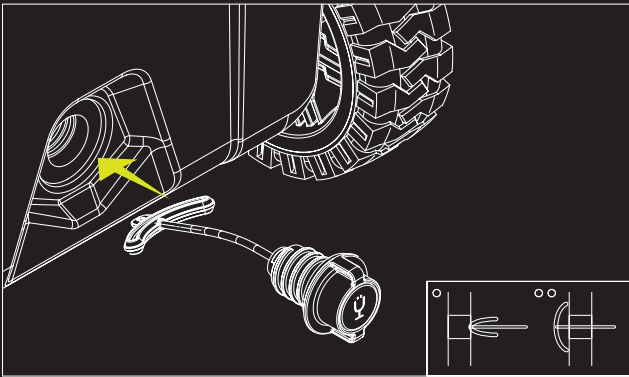

Loosen and pull out the drain plug until the stopper is engaged.
Tilt the cooler at an angle to ensure you drain the cooler completely.

How to Vent the Drink Tank

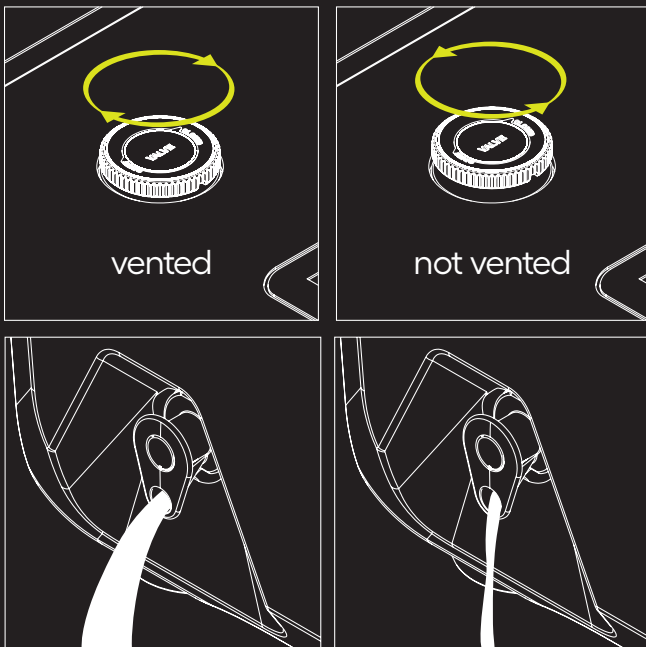

Turning the dial on the lid allows the cooler to vent ensuring your drinks flow smoothly.

Removing the Tank Lid

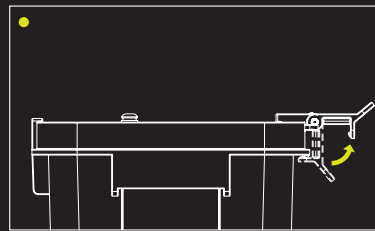

Pull up on the hinged closure to remove lid.

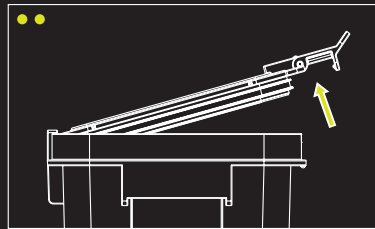

Cleaning Instructions

- 01 Unscrew the tap or plug and remove the tank
- 02 Clean the tank and cooler with a mild dish detergent and hot water
- 03 Rinse the tap thoroughly with hot, soapy water and allow all components to dry completely
- 04 Ensure components are tightly fastened before use to prevent leakage

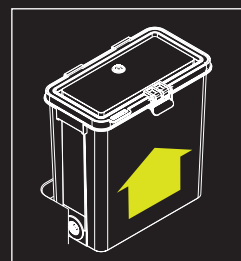

ProTip: After use, clean your BrūTank with a mixture of mild soap and warm water. Make sure to remove the drink tank after each use to ensure no moisture gets trapped underneath, and clean other areas prone to debris collection like the drain plug and lid gasket. Completely dry your BrūTank before storing with the lid closed.