

Top Tips *with* *Annie Sloan®*

Tin Opening

Annie Sloan's Wax, Lacquer and Paint tins are all manufactured to an industry standard, in line with competitors.



Chalk Paint™ tins are sealed extra tight. This ensures they remain air-tight and free from contamination.

To open tins, we recommend using a tin opener from a local hardware store. Of course, Annie recommends visiting your local independent where possible!

If you cannot get hold of a tin opener, you can use a blunt tool such as a spoon. Please do not use a sharp object such as a knife or screwdriver, these can cause serious injury if used incorrectly.

Opening the tin

- Ease the tin opener between the top of the lid and the edge of the tin.
- Apply slight pressure and lift upwards.
- Turn the tin a few degrees and repeat the motion. You will feel the air tight seal break and hear a “pop” noise.
- Continue turning the tin until you have covered the whole circumference of the lid before attempting to prise the lid completely off.
- Be as gentle and light handed as possible.
- Following these steps will prevent the lid buckling or damaging the tin.

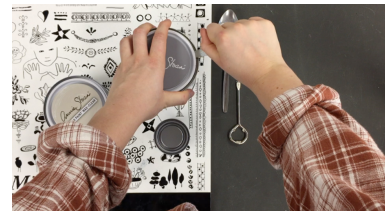

Closing the tin

- To secure the lid after use, set in place on the top of the tin.
- Place both palms on the lid and apply pressure down until you hear a “pop”.



The Wax, Lacquer, and Chalk Paint™ tins are all the same, so you can use this method with every Annie Sloan tin.

All metals are susceptible to some bending and denting if not handled gently.