

Wall-mounted shower Installation Instruction

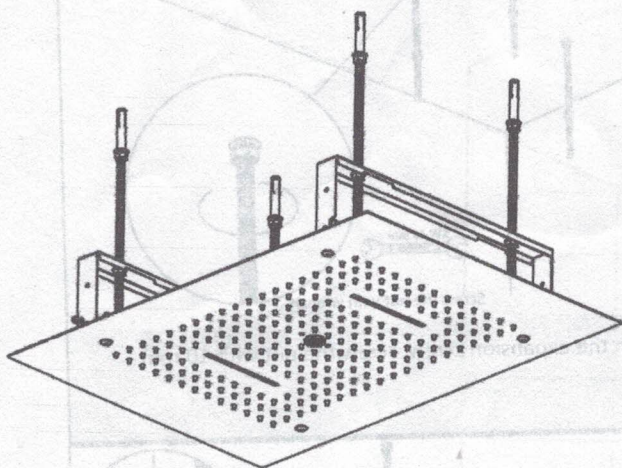

ITEM.NO:

1. Installation Condition

1. Refer to the 《Standard Part List》 when you open package, check all parts available.
2. Do not disassemble mixer body by yourself.
3. Determine inlet pipes and supply stopper have been installed and cleaned, also ensure no impurities in pipeline.
4. When finished installation, check all joints and connections for leaks.

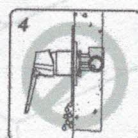
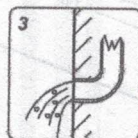
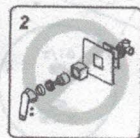

Warn: After conceal the accessories which embedding in the wall, do no envelop wall until test no leakage.

2. Safe Notes



- △ Gloves should be worn during installation to prevent crushing and cutting injuries.
- △ Children as well as adults with physical, mental and/or sensoric impairments must not use this shower system without proper supervision. Persons under the influence of alcohol or drugs are prohibited from using this shower system.
- △ Do not allow the streams of the shower touch sensitive body parts (such as your eyes). An adequate distance must be kept between the shower and you.
- △ The hot and cold supplies must be of equal pressures.

3. Standard Part List

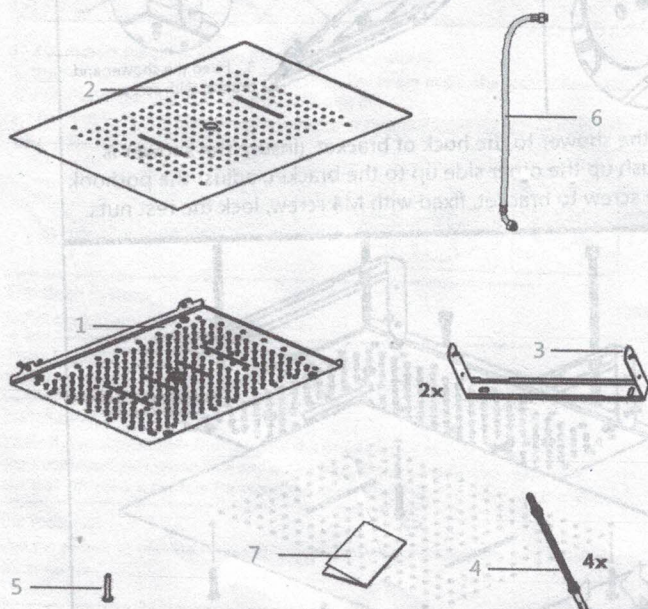

NO	Part Name	Quantity	NO	Part Name	Quantity
1	Shower head	1	7	Installation Instruction	1
2	Panel	1	8		
3	Holder	2	9		
4	M6 Anchoring	4	10		
5	M6 Screws	4			
6	Braided hose	1			

4. Essential Dimension Diagram

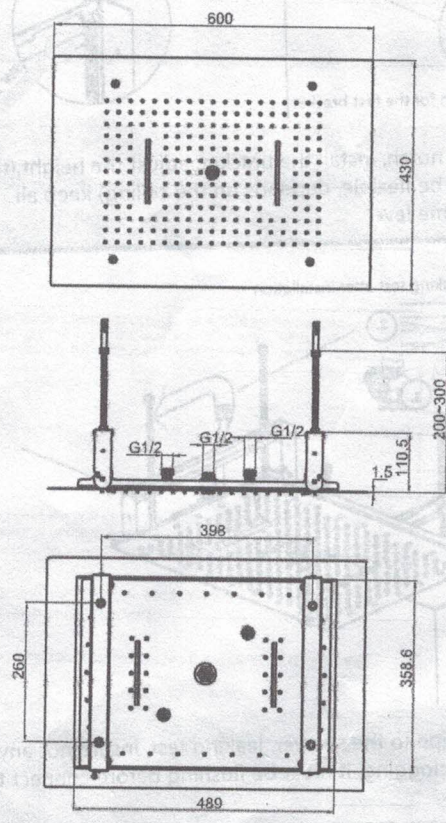

We will update and improve the design and the function, we will keep the right to change the size, we will not advise of that time again.

5. Installation Step

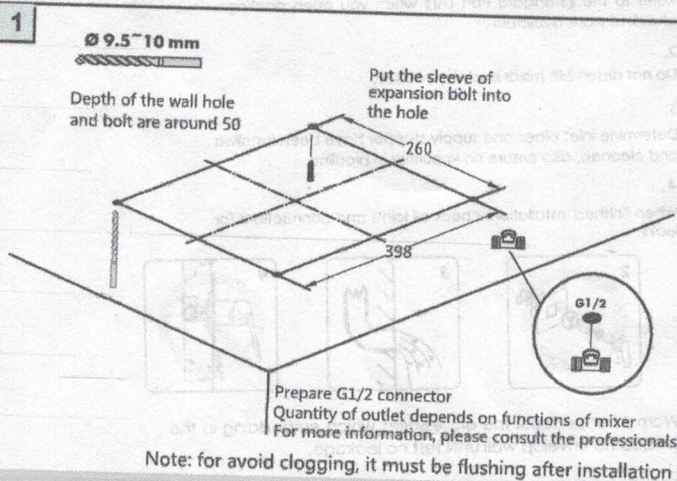

1. Refer the size of frame, positioning, drilling the wall hole in around 50 mm with 9.5-10mm drill.

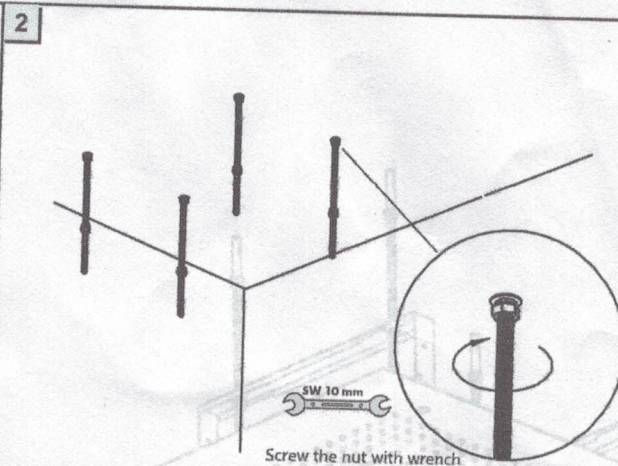

2. Screw on the expansion screw, screw the nut with 10 mm wrench

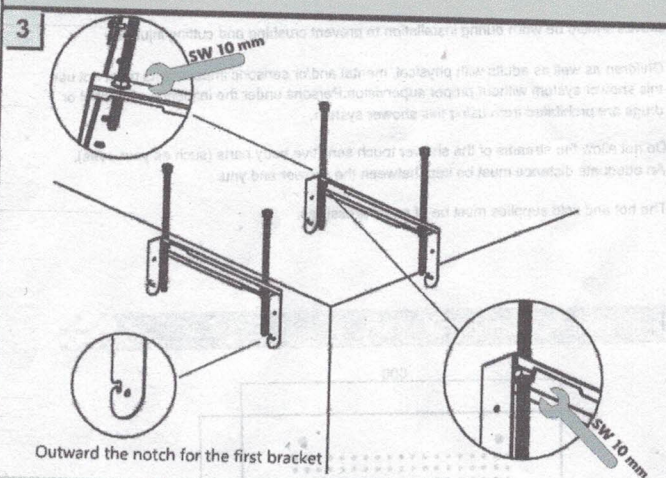

3. Outward the notch, install the bracket, adjust the height, (the height could be flexible, depends on the ceiling) keep all bracket in same level

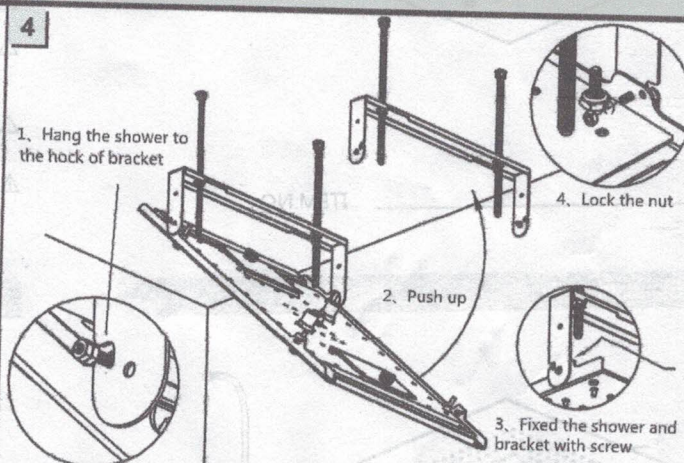

4. Hang the shower to the hock of bracket. (insure the shower is stable), push up the other side up to the bracket, adjust the pothook, hang the screw to bracket, fixed with M4 screw, lock the rest nuts.

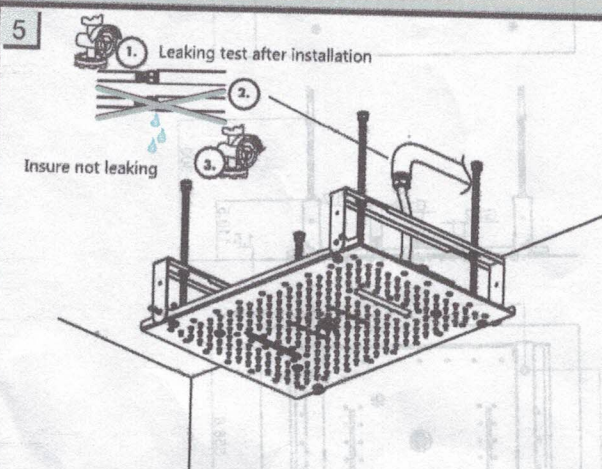

5. Connect the pipe to the shower, leaking test, insure not any leaking (for avoid clogging, it must be flushing before connect the pipe)

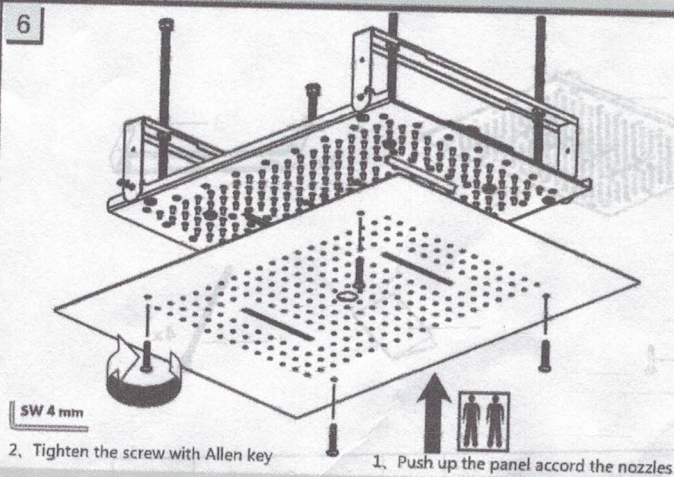

6. (note: This process requires two man), with gloves, Push up the panel accord the nozzles, tighten the screw with 4mm Allen key (keep the panel in same level with ceiling)

Hand injury risk warning

Hand injury risk warning

Note: Must be wear gloves to protect hands without incised wound

Process by professional

Combined installation sample

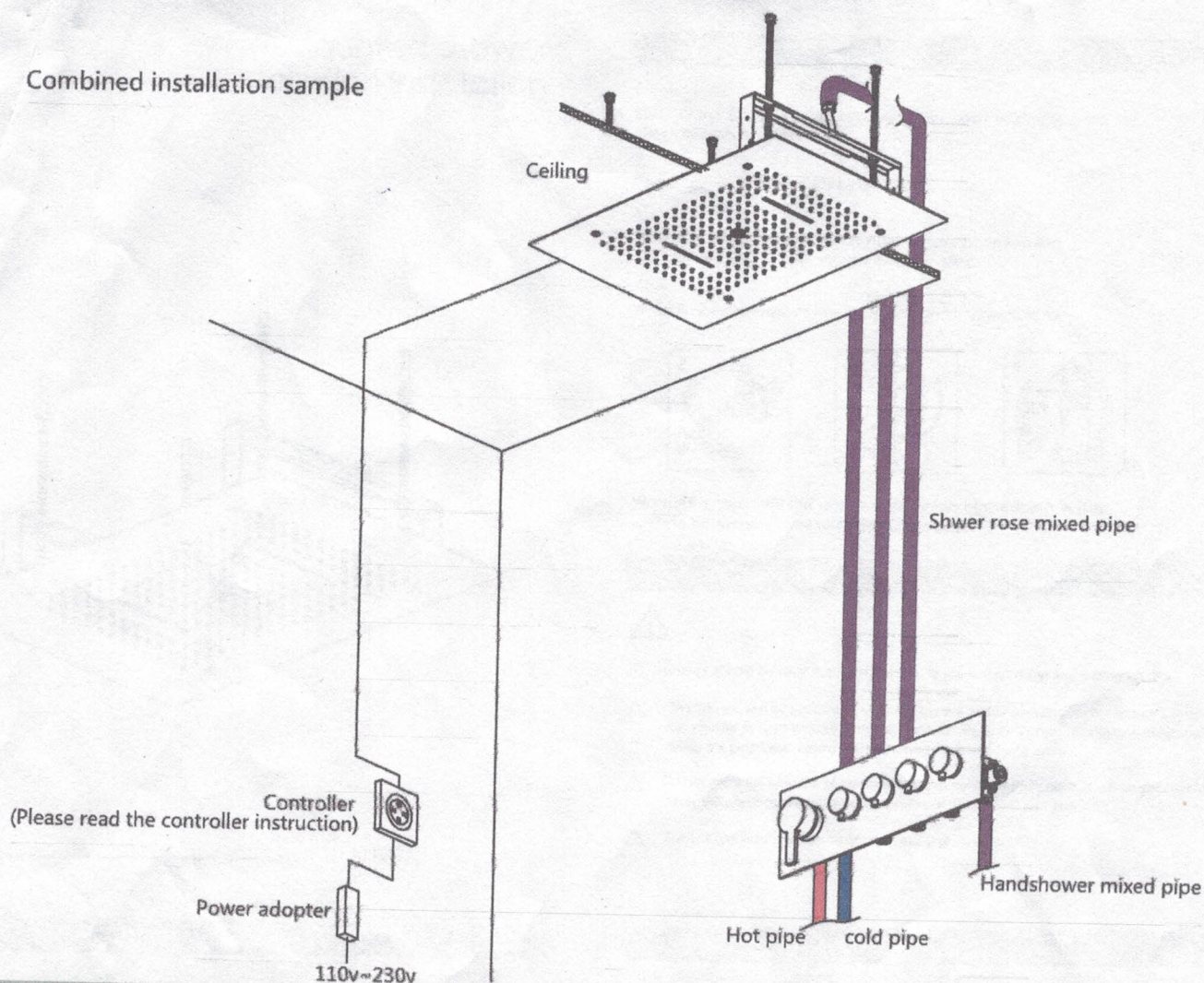

6. Application Instruction

1. For protect the valve, please turn on the faucet slowly.
2. Turn on the faucet by turn up the handle. The larger angle, the greater flow rate, the smaller angle, the less flow rate. Until turn off.
3. Turn left for the hot water and turn right for the cold water on the base of turn up the handle.

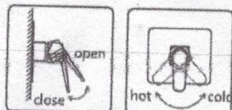

The flush system

Install the hot and cold water supply pile.

How to install the head shower properly.

The head shower must be connected behind the check valve of the faucet.

Installation environment

While the qualified professional install the product, please note: make sure the installation area smooth(no any projecting joint or ceramic tile). Make sure the wall structure is suitable for install the product and no any defect on the wall.

Fix material

Use the proper fix material only. The attached screw and screw bolts only suitable for concrete

Electrical connection

Please install the cable 230v/N/PE/50Hz first.(must be installed by the electrician)

Turn on/off the light

It must be installed outside the bath area. Or connect with the ceiling light.
(Please refer the belowing Electrical connection drawing)

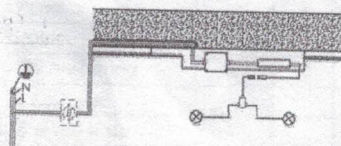

7. Care and Maintenance

In order to keep the mixer surface bright, please keep often or regularly to clean the mixer.

- Wash faucet with clean water, and wipe with soft cotton cloth.
- Avoid using cleaning powder, harsh cleaning brushes, and cloth with coarse surface to prevent scratching and corrosion.
- Do not use acidic cleaning agents for washing the faucet as it may cause corrosion on the surface of faucet. Rinse off with water immediately if the faucet in contact with harmful acidic agents.

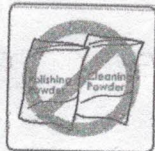
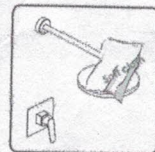

Use clear water and the soft cloth, eliminate the superficial dirt and the filthy membrane as far as possible.

1. Use clear water and the soft cloth, eliminate the superficial dirt and the filthy membrane as far as possible..
2. Use the any following cleanser to remove the superficial dirt and the filthy membrane.
 - Temperate liquid cleanser cleanser.
 - The colorless glass cleaner, close not have the powdery cleanser which the abrasive action and can dissolve completely(according to instruction mix).
 - Polish liquid which does not abrasive action.

3. After clealy, please remove the complete cleansing agent with the clear water, and wipes with soft cotton fabric.

ITEM.NO:

Wall-mounted shower Installation Instruction

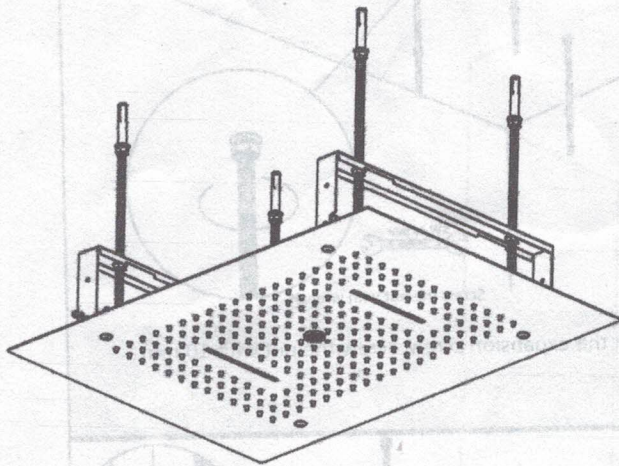

ITEM.NO:

3. Standard Part List

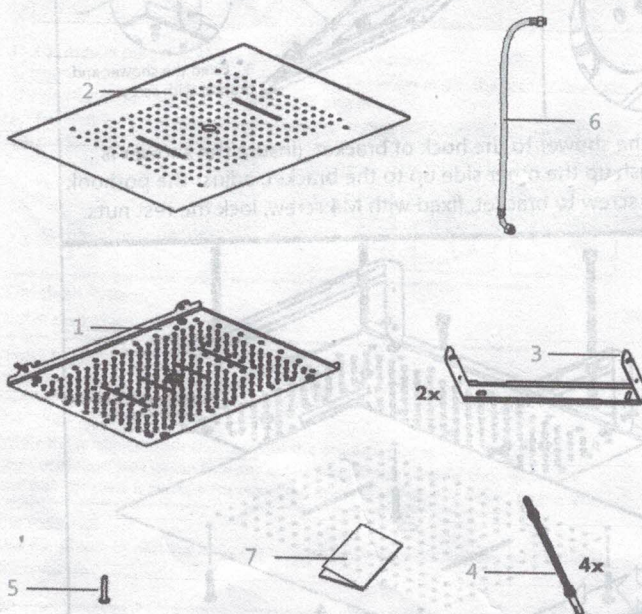

NO	Part Name	Quantity	NO	Part Name	Quantity
1	Shower head	1	7	Installation Instruction	1
2	Panel	1	8		
3	Holder	2	9		
4	M6 Anchoring	4	10		
5	M6 Screws	4			
6	Braided hose	1			

1. Installation Condition

1. Refer to the 《Standard Part List》 when you open package, check all parts available.
2. Do not disassemble mixer body by yourself.
3. Determine inlet pipes and supply stopper have been installed and cleaned, also ensure no impurities in pipeline.
4. When finished installation, check all joints and connections for leaks.

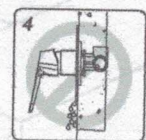
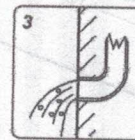
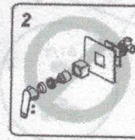

Warn: After conceal the accessories which embedding in the wall, do no envelop wall until test no leakage.

2. Safe Notes



- △ Gloves should be worn during installation to prevent crushing and cutting injuries.
- △ Children as well as adults with physical, mental and/or sensoric impairments must not use this shower system without proper supervision. Persons under the influence of alcohol or drugs are prohibited from using this shower system.
- △ Do not allow the streams of the shower touch sensitive body parts (such as your eyes). An adequate distance must be kept between the shower and you.
- △ The hot and cold supplies must be of equal pressures.

4. Essential Dimension Diagram

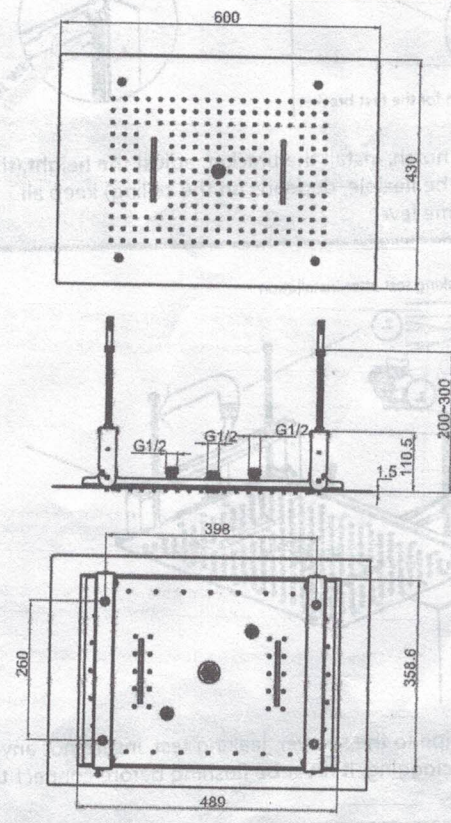

mm

We will update and improve the design and the function, we will keep the right to change the size, we will not advise at that time again.