



F L E X S T E E L ®

# Battery Pack 3

## Instruction Manual

### Contents

1. Safety Instructions	2
2. Features	3
3. Charging	4
4. Use	6
5. Maintenance	6
6. Specifications	7
7. Disposal	8
8. FAQs	8
9. Physical Dimensions	9

Thank you choosing a Flexsteel product and placing your trust and confidence in us. The following operating instructions contain important information on assembly, use, maintenance, and troubleshooting.

For further questions, please contact our customer service department.

# 1. Safety Instructions

Please carefully read and follow the instructions to ensure the safe use of the battery pack. Failure to follow the instructions may cause injury. The use of this battery pack with devices not authorized by Flexsteel is NOT recommended and may void the product warranty.

**\*\*\*\*\* KEEP OPERATING INSTRUCTIONS IN A SAFE PLACE. \*\*\*\*\***

**Carefully read these operating instructions prior to using the device.**

- Ensure that every person involved in the use, connection, or installation of the operating of the battery pack has been sufficiently instructed and always has access to these operating instructions.
- Children should not operate the battery pack. Both during storage and operation, ensure that the battery pack is not accessible to children.
- Do not store the battery pack in locations where the temperature may reach greater than 50°C (122°F) (e.g., vehicle interior at high outside temperatures, etc.).
- Do not immerse the battery pack in water or other liquids at any time. Protect the battery pack from splashing water and moisture. For normal cleaning, wipe with a damp cloth. Do not store or operate the battery pack in extreme high levels of moisture and humidity.
- Protect and keep the battery pack away from fire.
- Protect the battery pack against severe power surges or mechanical loads. Do not operate the battery pack if damage to the housing or cable is visible. If the battery case or wires are damaged, suspend use immediately.
- During operation, be aware of unusual noises or uneven functioning. Deactivate the battery pack in the case of these unusual occurrences.
- Do not open or modify the battery pack. There are NO user-serviceable parts in the battery pack.
- Damaged cables or devices should only be replaced or repaired by the manufacturer or qualified persons.
- The battery pack may only be charged and/or operated with Flexsteel-approved devices. The use of the battery pack with other chargers or devices not approved and/or supplied by Flexsteel is prohibited and may result in personal injury or property damage.

- The battery pack may be charged only at an ambient temperature ranging from 0°C (32°F) to 40°C (104°F).
- Do not cover the battery pack while charging.

## 2. Features

- The battery pack consists of 25.2V/2.6Ah lithium ion rechargeable batteries.
- The battery pack can provide up to 300 complete cycles (from upright to reclined and back to upright) with load of 80kg (175 lbs.) on one charge. The quantity of cycles will decrease or increase depending on load size. Some furniture features optional USB ports. Using the USB ports will consume power from the battery pack and will decrease the quantity of cycles for that charge.
- Works during a power outage
- The battery pack may be used to operate the furniture while simultaneously being charged.
- The battery pack **should not be used** on lift reclining furniture. It is also not recommended on 601M or 604P styles with cup holder controls, 59H styles with touch controls, styles with Bluetooth features, or styles containing USB ports with no USB cutoff or zero-draw features (see Flexsteel Control Type Document included with furniture) as these features will drain the battery and greatly decrease the number of cycles.

### Warning Signs of Low Battery

**Red LED** - A SOLID red LED indicates the battery pack is being charged.

**Green LED** - A SOLID green LED means the battery pack is fully charged (after eight hours). The green light goes out when the battery pack is plugged into the furniture or is in standby mode.

**Audible Beeping** - The beeping signal warns the user that the charge is VERY LOW and the battery pack must be charged.

### 3. Charging

**\*\*\*\*\* IMPORTANT! \*\*\*\*\***

**PRIOR TO INITIAL USE, FULLY CHARGE THE BATTERY PACK FOR 8 HOURS.**

1. Connect the battery pack (A) to the transformer (B) (supplied with furniture). Use the supplied extension cord if needed.

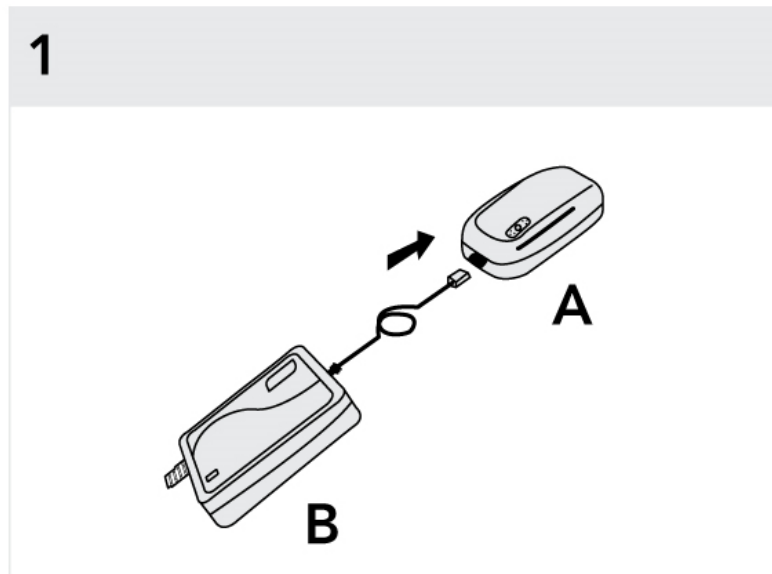

2. Plug the connected transformer (B) and battery pack (A) into a 120V outlet.

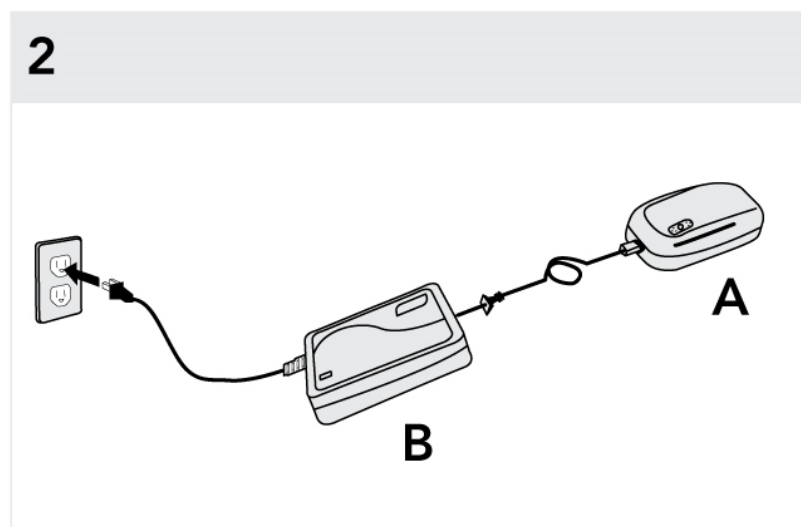

3. **SOLID RED LED** when charging. **SOLID GREEN LED** indicates fully charged.

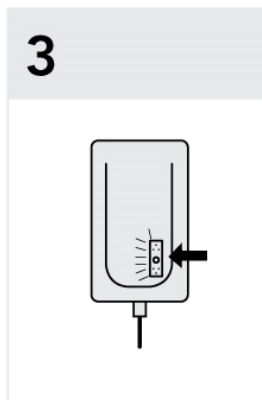

4. To disconnect from charging, first unplug the transformer (B) from 120V outlet.

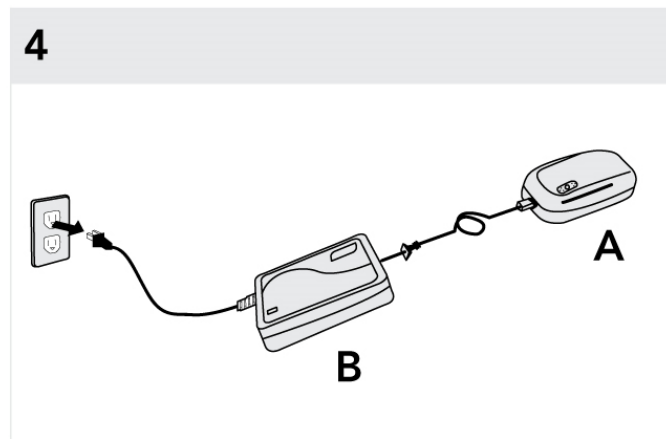

5. Then disconnect the battery pack (A) from the transformer (B)

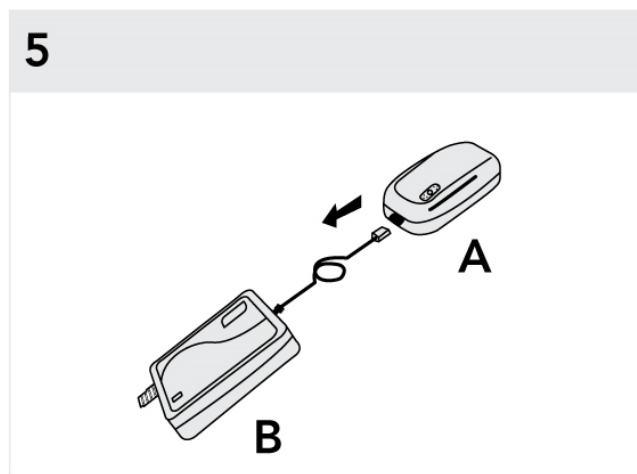

## 4. Use

1. Plug the battery pack (A) into the power recline cable coming out of the rear of the furniture. The battery pack should be positioned one foot behind the furniture to ensure that the battery pack does not interfere with the furniture recline movement. All cables should be neatly secured so as to not get pinched in the mechanism. Please note that improper installation of the battery pack will void the warranty.

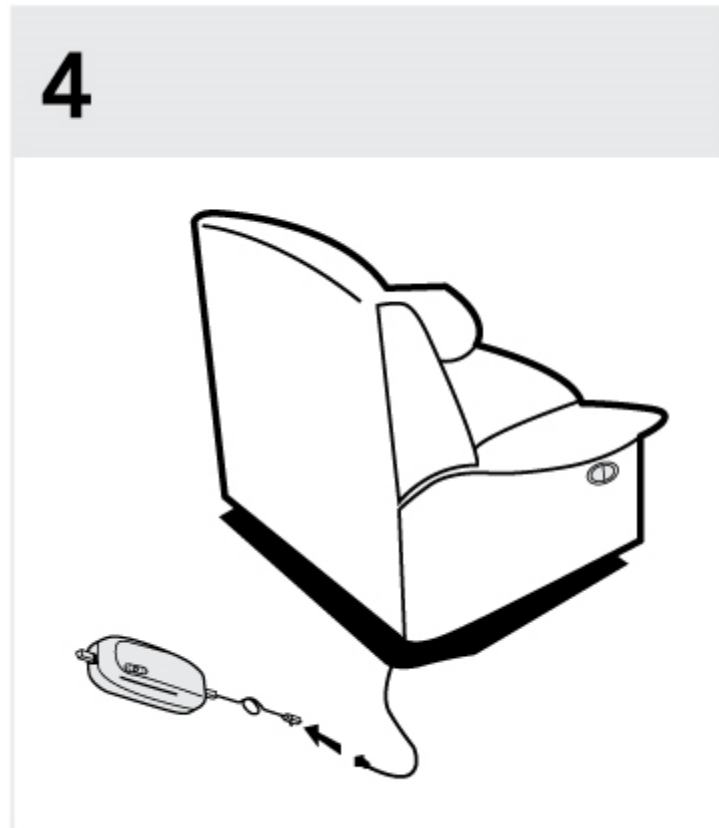

**\*\*\*\*\* IMPORTANT! \*\*\*\*\***

**DO NOT DRAIN BATTERY COMPLETELY. IF BATTERY IS ALLOWED TO BECOME COMPLETELY DRAINED, IT MAY BECOME DIFFICULT TO RECHARGE.**

## 5. Maintenance

Do the following at regular intervals for the housing, cables, and connector of the battery pack:

- Remove dust and dirt with a slightly damp cloth.
- Every six months, visually inspect the battery pack to check for damage and wear.
- Ensure all wires are firmly connected.
- The battery pack must never be fully drained. For this reason, the battery pack, when unused, should always remain connected to the transformer to ensure full capacity.

## 6. Specifications

Item	Description
Nominal capacity (average)	2600mAH
Minimum capacity	2550mAH
Rated voltage	25, 2V
Cycle capacity	80% residual capacity after 300 cycles
Input charge voltage	29.4 VDC
Cell-end voltage	The lowest unit cell voltage less than 2.7V
Maximum output current	<5A DC
Output cut-off current	10A
Acoustic signal at	21.5V
Dimensions	175 mm. (L) x 90 mm. (W) x 50 mm. (H)
LED display when charging	Red solid: the battery pack is being charged
LED display when charged	Green solid: the battery pack is fully charged
Weight	560g
Feature	Single-cell protect circuit

## 7. Disposal

Upon discontinued use, this product must be disposed of as electronic waste in accordance with the disposal regulation of your district/country/state. Do not dispose of in fire.

## 8. FAQs | Troubleshooting

**Q:** How often should I charge the battery pack?

**A:** The batteries should be recharged after 300 cycles or every two weeks. Recharge for a minimum of 8 hours.

**Q:** Where should I position the battery pack while it is plugged in to the furniture?

**A:** The battery pack should be positioned one foot behind the furniture. Ensure that the battery pack does not interfere with the furniture's reclining movement and that all cables are neatly secured to avoid pinching them in the mechanism. Allow a sufficient amount of cable length exposed to prevent the battery pack from being dragged across the floor during the reclining cycle. This can cause the battery pack to become disconnected. Extension cables may be purchased through your authorized Flexsteel retailer if necessary.

**Q:** Can I charge more than one battery pack at a time off of one transformer?

**A:** No; only charge one battery pack per transformer.

**Q:** Can I leave the battery pack plugged in and operate the furniture while charging?

**A:** Yes.

**Q:** What happens if the battery pack completely discharges in mid-recline?

**A:** You or another person will need to plug the transformer into the battery pack to bring the furniture back to its upright state. You can avoid the battery pack discharging mid-cycle by making sure you charge the battery pack when you hear the low-battery warning (beeping).

**Q:** My furniture will not be used for an extended period of time (over one month). What should I do with the battery pack?

**A:** When unused, the battery pack should always remain connected to the transformer to ensure full capacity.



# 9. Physical Dimensions

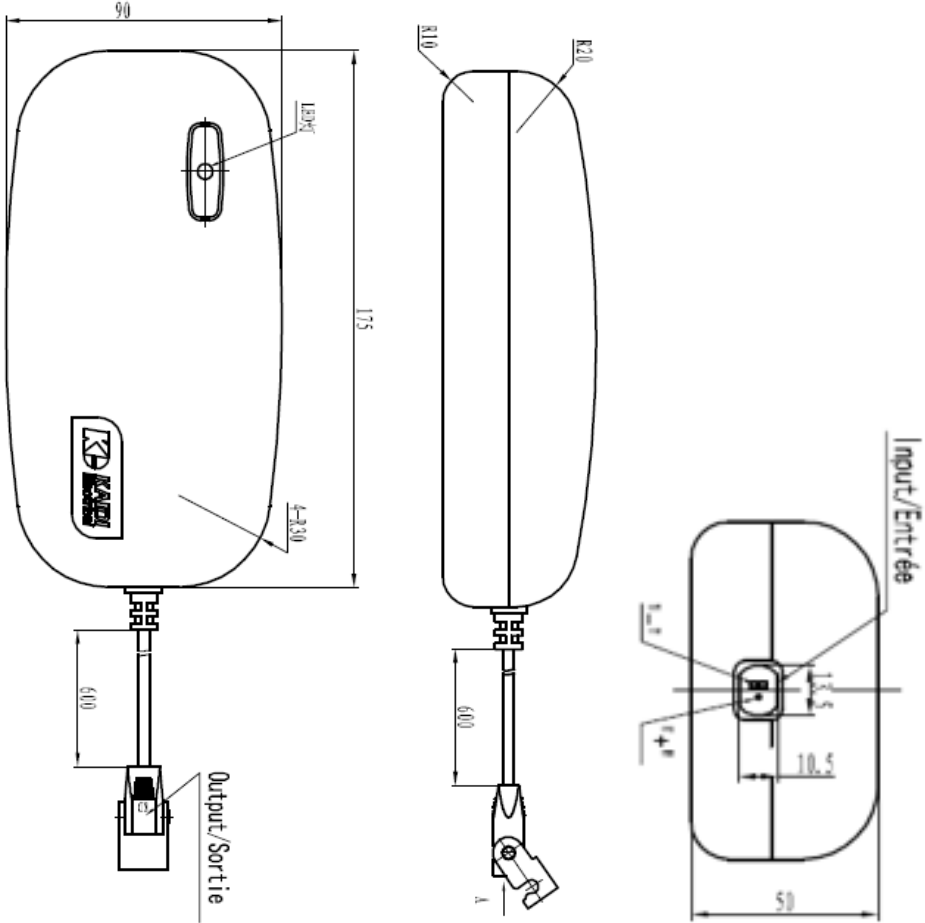

Thank you for choosing and using the Flexsteel battery pack with your fine furniture. We stand behind our product. For additional information contact us at [www.flexsteel.com](http://www.flexsteel.com).