



Christmas Goose Cushions

(Beige colourway and Laurel colourway)

The Happy Holidays quilt has many motifs that would make lovely smaller projects, so why not make some cushions to go with your quilt? We've chosen the goose motif from the quilt, framed it with a border and made it in two colourways. The cushion with the beige background is described in detail and for a cushion with a festive laurel background, go to the end of the instructions for the Materials list, Fig A and Fig B for that cushion. For the quilt instructions visit tildasworld.com

Difficulty rating **

Materials (Beige Cushion)

- Fabric 1: $\frac{3}{8}$ yd (40cm) – Eucalyptus beige (110090)
- Fabric 2: 10in (25cm) square – Chambray dark blue (160007)
- Fabric 3: two pieces $2\frac{1}{4}$ in x $1\frac{1}{2}$ in (5.7cm x 3.8cm) – Autumn Bloom old rose (100529)
- Fabric 4: 10in (25cm) square – Solid rust (120017)
- Wadding (batting): 17in (43cm) square
- Lining fabric: 17in (43cm) square (optional)
- Fabric for back of pillow: $\frac{3}{8}$ yd (40cm) – Chambray blush (160002)
- Binding fabric: $\frac{1}{4}$ yd (25cm) – Olive Branch blush (110087)
- Piecing and quilting threads
- Black stranded embroidery thread for French knot eye
- Quilter's ruler, rotary cutter and mat
- Five buttons for fastening (optional): Hibernation buttons 16mm (400059)
- Cushion pad to fit cover

Fabric Notes

If you have made the Happy Holidays Quilt you may have left-overs you can use.

Finished Size

15½in (40cm) square

General Notes

- Fabric quantities are based on a usable width of 42in (107cm), unless otherwise stated.
- Measurements are in imperial inches with metric conversions in brackets – use only *one* system throughout (preferably inches). Width measurements are generally given first.
- Before using your fabrics, press before cutting and trim as needed to square up the fabric pattern/weave, using a quilting ruler to cut the top raw edge at 90 degrees to the selvages.
- Use $\frac{1}{4}$ in (6mm) seams unless otherwise instructed.
- Read all the instructions through before you start.

Cushion Layout

1 The cushion is made up of a single goose block, framed by a border in two widths. See **Fig A** for the fabrics used and **Fig B** for the cushion layout and fabric positions.

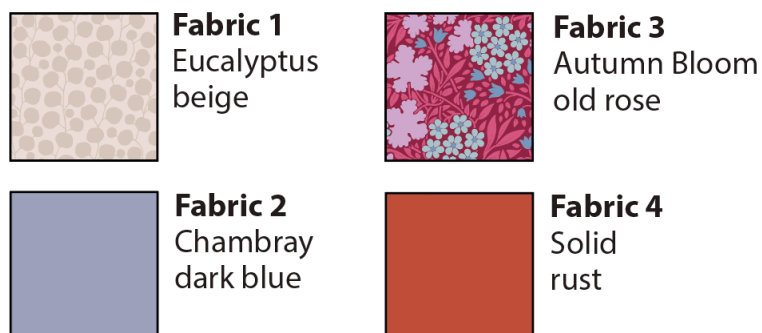
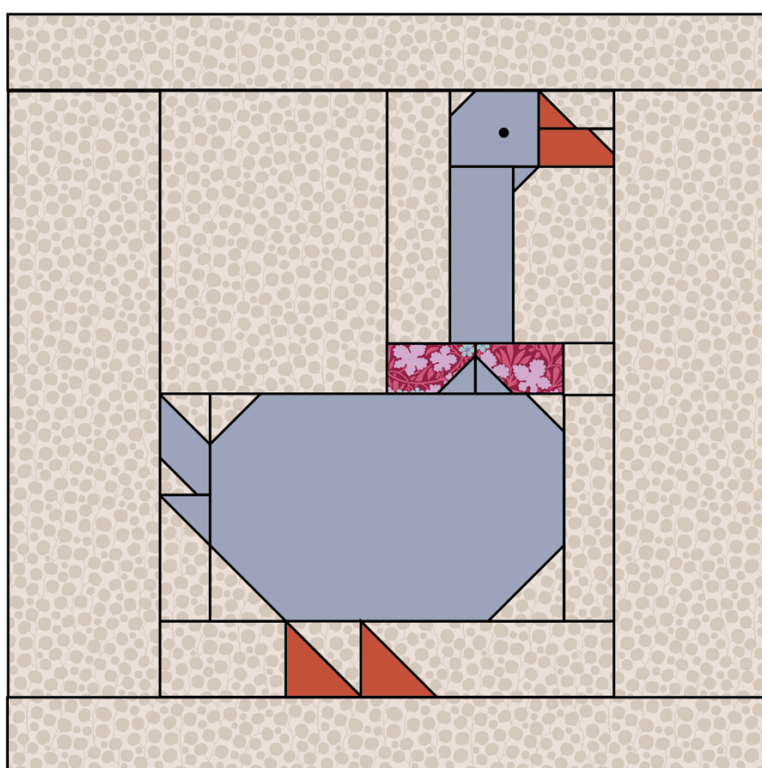
Fig A Fabric swatches (Beige colourway)**Fig B** Cushion layout and fabric positions

Cutting Out

2 Refer to the measurements given in **Fig C** for cutting the fabrics. Cut the large Fabric 1 border pieces first, keeping the remainder of the fabric for the block.

3 To cut the fabric for the back of the cushion, remove any selvages and cut the fabric into two pieces each 16in x 11in (40.6cm x 28cm).

4 Cut the binding fabric into three strips 2½in (6.4cm) x width of fabric. Sew them together end to end and press seams open. Press in half along the length, wrong sides together.

Fig C Cut measurements for the Goose cushion

Sizes include seam allowances

All pieces to be cut initially as squares or rectangles

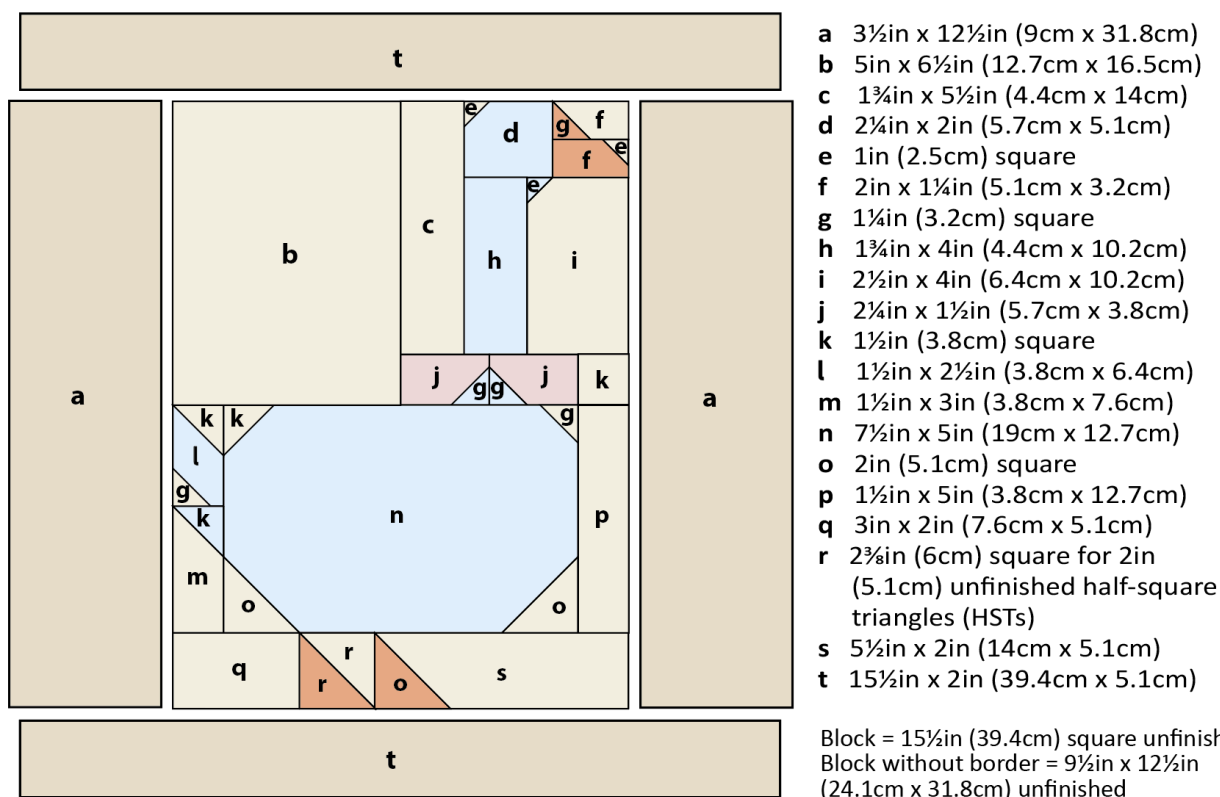

Making the Block

5 The block uses a half-square triangle unit and various corner triangle units, so these will be described first.

Half-Square Triangle Unit: The method described here makes two units at the same time, so one will be spare. Take a Fabric 1 and Fabric 4 square, each 2¾in (6cm), and on the wrong side of the lighter square, pencil mark the diagonal line (**Fig D**). Place the two squares right sides (RS) together and sew ¼in (6mm) away from the marked line on both sides, as shown. Cut the units apart along the marked line and press the units. The seam is normally pressed towards the darker fabric. Check each unit is 2in (5.1cm) square (unfinished).

Corner Triangle Units: Corner triangle units occur in various places in the block. A triangle may only be needed on one corner or more. The sizes of the pieces will vary depending on the motif, so follow the cutting measurements carefully. Regardless of the size though, the basic method is the same – see **Fig E**. Take the larger piece of fabric and place it right side (RS) up. Take the smaller square and pencil mark the diagonal line on the wrong side. Pin the square right sides together with the larger piece of fabric, aligning the edges as shown and with the diagonal line in the direction needed. (Note: the position of the square and the direction of the marked line will vary depending on the unit you are making.) Sew along the marked line. Trim off excess fabric ¼in (6mm) outside the sewn line and press the triangle outwards. Make all the corner triangle units needed for the block.

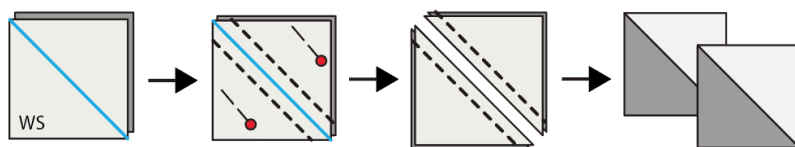
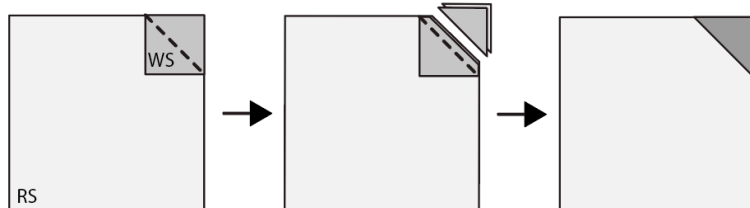
Fig D Making half-square triangles**Fig E** Making corner triangle units

6 When all pieced units have been made, assemble the block following the stages shown in **Fig F**. If you lay out all the pieces in the shape of the block it will be easier to identify what pieces get sewn together first. Press seams open or to one side. Check the sewn block is has an unfinished size of $9\frac{1}{2}$ in x $12\frac{1}{2}$ in (24.1 cm x 31.8cm).

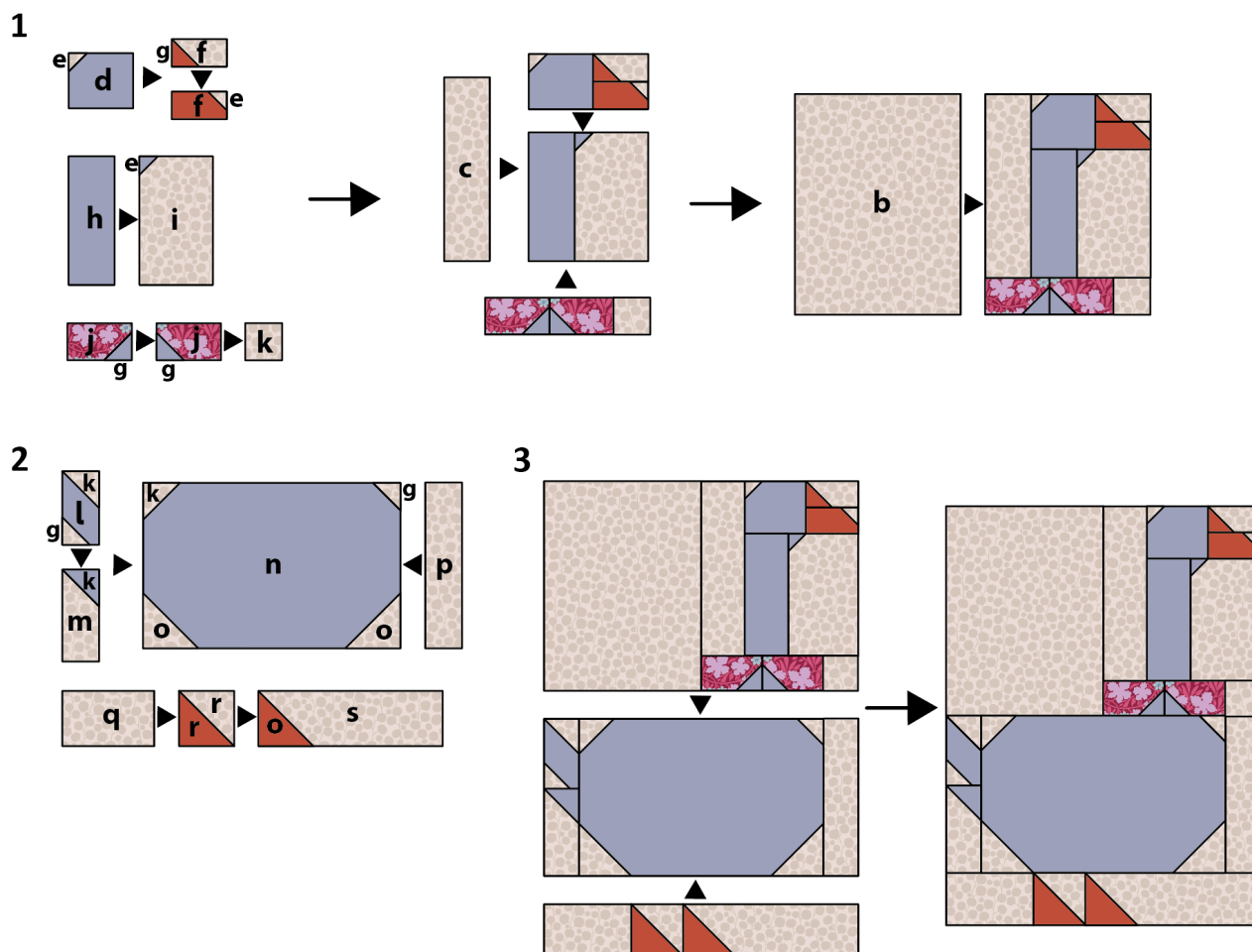
Fig F Assembling the patchwork

7 To add the border, sew the shorter border strips to the sides of the block and press the seams outwards (**Fig G**). Now sew the longer border strips to the top and bottom of the block and press seams outwards. The block should be $15\frac{1}{2}$ in (39.4cm) square (unfinished). Add the French knot eye, using six strands of black stranded cotton wound twice around the needle.

Fig K Adding the border

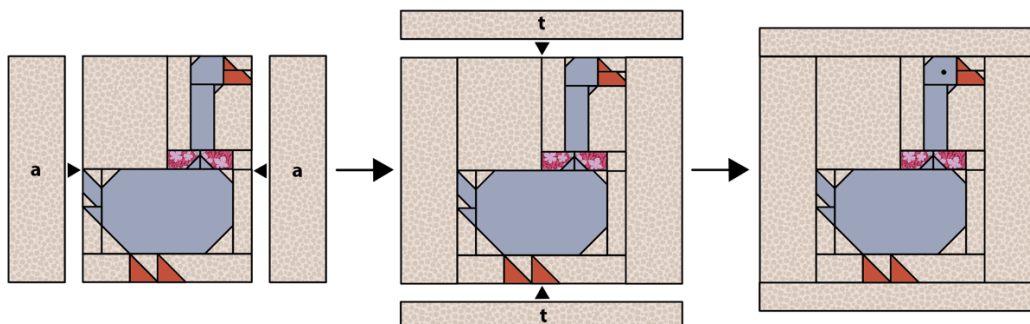

Quilting and Finishing

8 Make a quilt sandwich of the patchwork, wadding (batting) and lining fabric (if using). Quilt as desired. Trim off excess wadding and lining fabric to match the patchwork size.

9 To make up the cushion cover, take the two pieces of fabric for the cushion back and on one long edge of each piece, create a hem by turning the edge over by 1in (2.5cm), twice. Sew the seams with matching thread and press (**Fig H**). The diagram is shown in greys, so use the Tilda fabric and buttons suggested in the Materials list, or those of your choice. For the fastening, using your sewing machine, create five equally spaced buttonholes within the hem of one of the pieces. Sew five buttons onto the other piece, matching their positions to the buttonholes. Note: Instead of making buttonholes, you could use a hook and loop fastening, such as Velcro to fasten the cover and sew on buttons as a decorative feature.

10 The cushion has a bound edge, so the pieces are assembled with right sides out, as follows. Place the quilted patchwork right side down. On the backing, fasten the buttons into the buttonholes and place the whole piece on top of the patchwork, right side up. Check it is the same size as the patchwork, trimming any raw edges if needed. Make sure the outer edges of all pieces are aligned. Pin or tack (baste) the layers together and then bind as normal. As you sew the binding in place it will fix the other layers together. Press the cover and insert a cushion pad to finish.

Fig H Making up with a button fastening

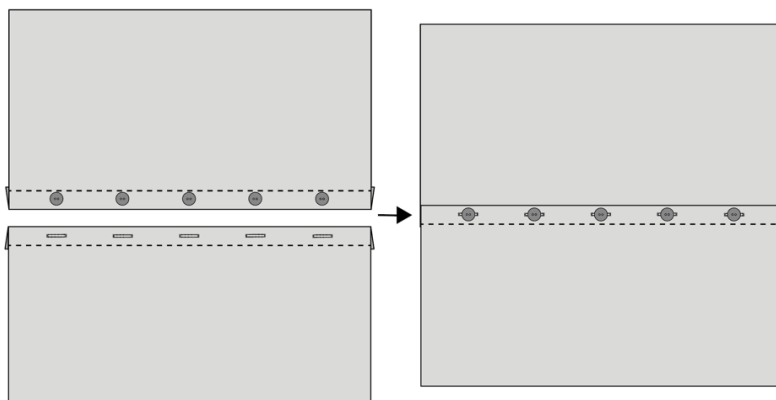

Christmas Goose Cushion

(Laurel colourway)

This version of the cushion uses a stronger background colour, with the green looking attractively festive. Use the Materials list given below and Fig A and Fig B, and then follow the making instructions given for the Beige Cushion.

Difficulty rating **

Materials (Laurel Cushion)

- Fabric 1: $\frac{3}{8}$ yd (40cm) – Olive Branch laurel (110094)
- Fabric 2: 10in (25cm) square – Solid dove white (120001)
- Fabric 3: two pieces $2\frac{1}{4}$ in x $1\frac{1}{2}$ in (5.7cm x 3.8cm) – Eucalyptus hibiscus (110088)
- Fabric 4: 10in (25cm) square – Solid rust (120017)
- Wadding (batting): 17in (43cm) square
- Lining fabric: 17in (43cm) square (optional)
- Fabric for back of pillow: $\frac{3}{8}$ yd (40cm) – Chambray sage (160011)
- Binding fabric: $\frac{1}{4}$ yd (25cm) – Winter Rose hibiscus (100527)
- Piecing and quilting threads
- Black stranded embroidery thread for French knot eye
- Quilter's ruler, rotary cutter and mat
- Five buttons for fastening (optional): Hibernation buttons 16mm (400059)
- Cushion pad to fit cover

Fabric Notes

If you have made the Happy Holidays Quilt you may have left-overs you can use.

Finished Size

15½in (40cm) square

General Notes

- Fabric quantities are based on a usable width of 42in (107cm), unless otherwise stated.
- Measurements are in imperial inches with metric conversions in brackets – use only *one* system throughout (preferably inches). Width measurements are generally given first.
- Before using your fabrics, press before cutting and trim as needed to square up the fabric pattern/weave, using a quilting ruler to cut the top raw edge at 90 degrees to the selvages.
- Use $\frac{1}{4}$ in (6mm) seams unless otherwise instructed.
- Read all the instructions through before you start.

Cushion Layout

1 The cushion is made up of a single goose block, framed by a border in two widths. See **Fig A** below for the fabrics used and **Fig B** for the laurel cushion layout and fabric positions.

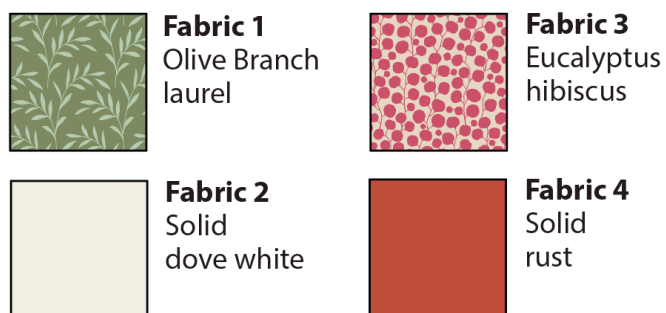
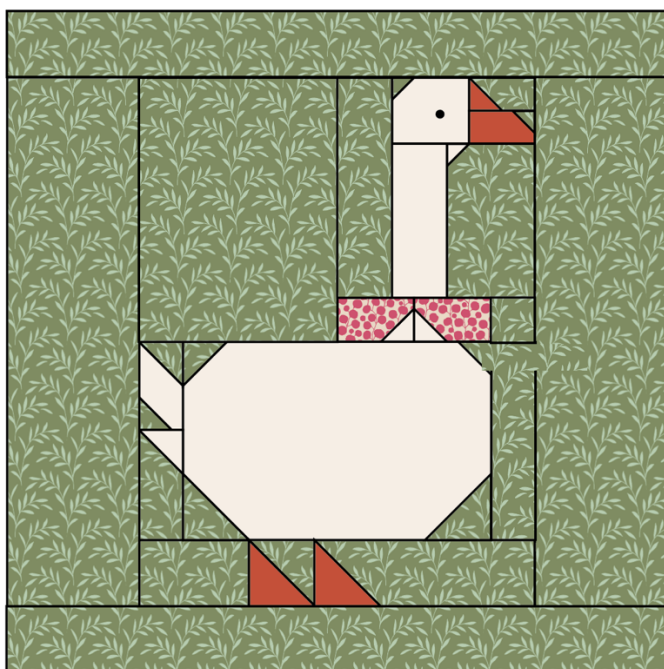
Fig A Fabric swatches (Laurel colourway)**Fig B** Cushion layout and fabric positions**Cutting Out**

2 Follow Steps 2–4 of the Beige Cushion but using the correct fabrics for the Laurel Cushion.

Making the Block

3 Follow Steps 5–7 of the Beige Cushion but using the fabrics for the Laurel Cushion.

Quilting and Finishing

4 Follow Steps 8–10 of the Beige Cushion, using the fabrics for the Laurel Cushion.