

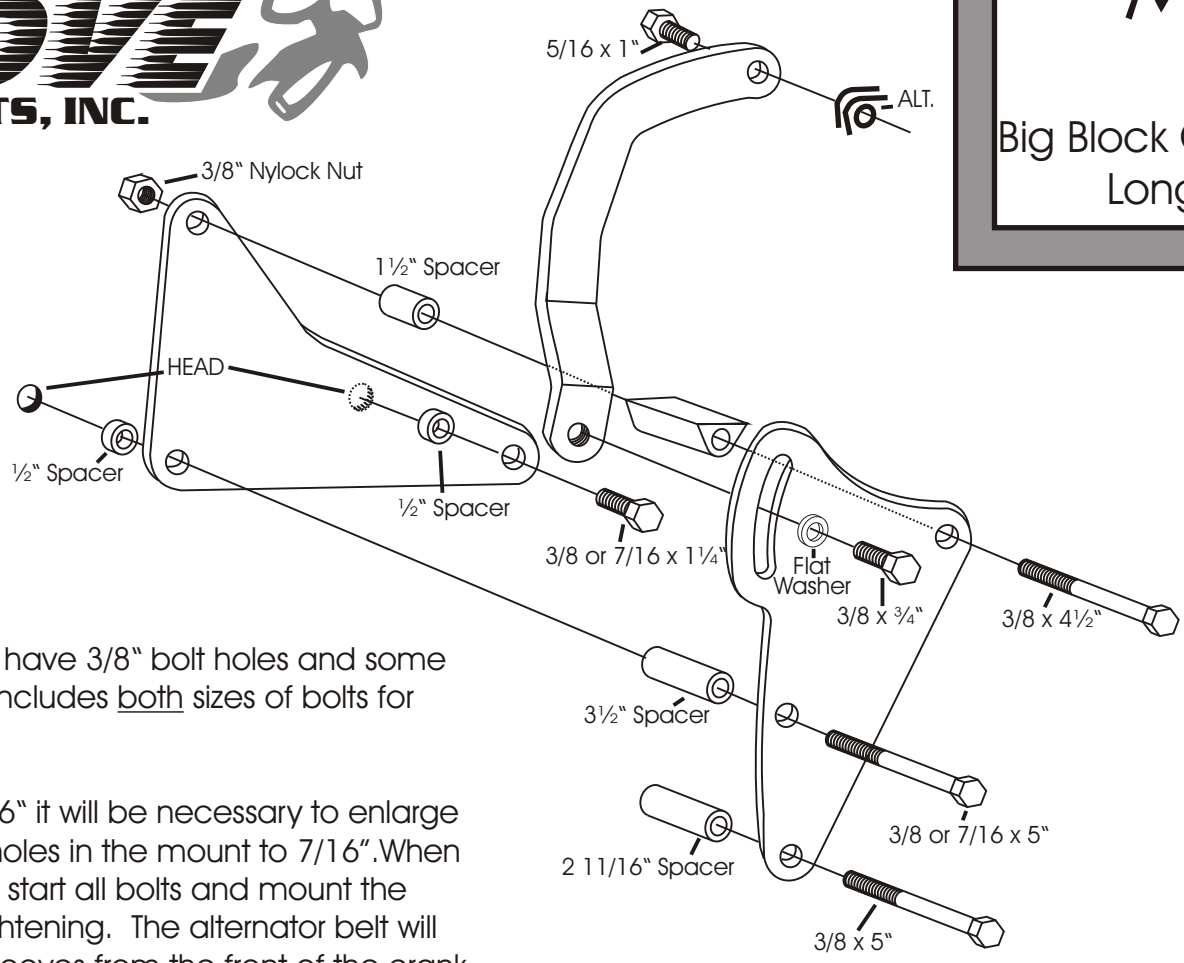

ALTERNATOR MOUNT 216L

Big Block Chevy - Driver's Side
Long Water Pump



NOTE: Some heads have 3/8" bolt holes and some have 7/16". This kit includes both sizes of bolts for these holes.

If your head has 7/16" it will be necessary to enlarge the corresponding holes in the mount to 7/16". When installing the mount, start all bolts and mount the alternator before tightening. The alternator belt will run in the second grooves from the front of the crank and water pump pulleys originally used for the factory compressor. It was designed to be used with our 116R Passenger Side Compressor Mount.

It can be used with single groove crank and water pump pulleys by using a double groove alternator pulley and running the belt in the outer groove.

(We use a belt length of 52-53" with this mount on installations in our shop. This was determined using GM Part #14025185 Crank Pulley and GM Part #14023155 Water Pump Pulley.)

As with any part of this nature, make sure it fits your application before painting or plating. Parts that have been painted, plated or modified may not be returned.

ALTERNATOR
MOUNT
216L

Big Block Chevy - Driver's Side
Long Water Pump

ALAN GROVE COMPONENTS, INC.
27070 METCALF ROAD
LOUISBURG, KS 66053