

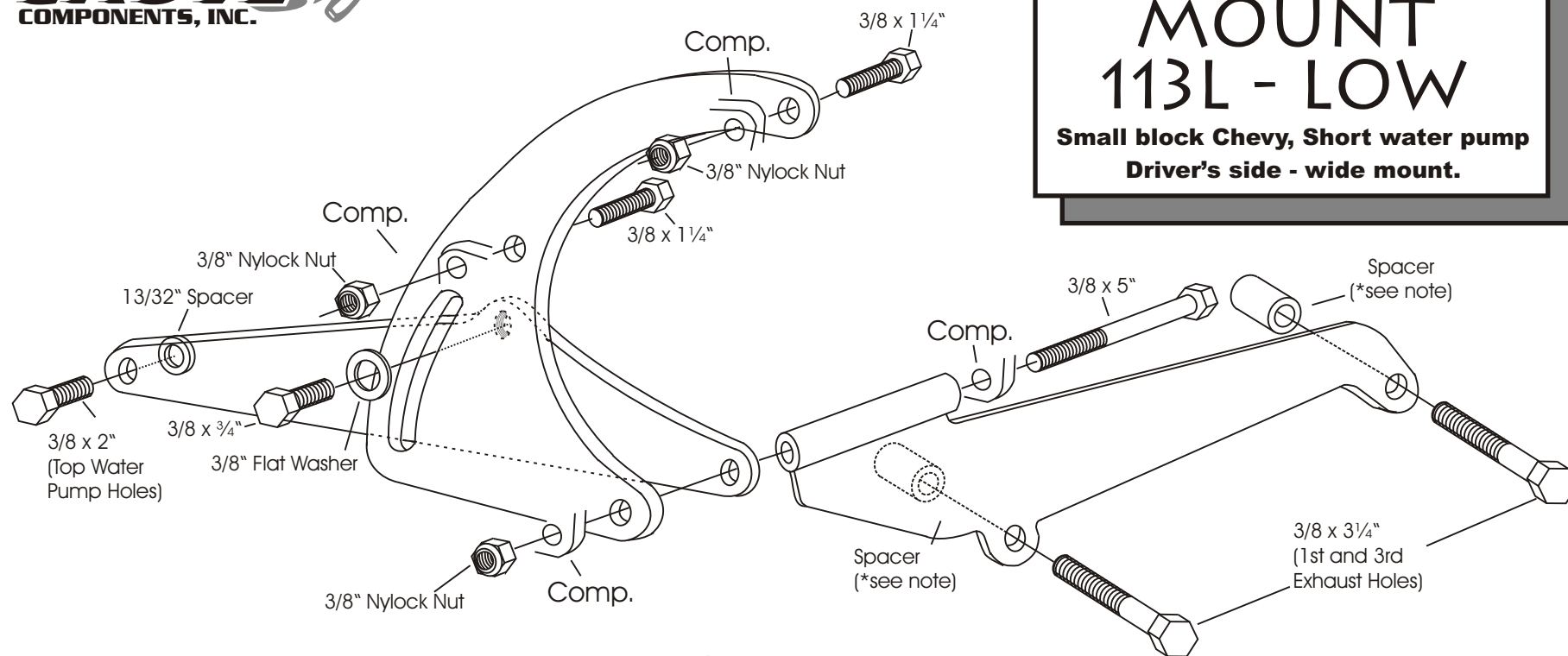

# A.C. COMPRESSOR MOUNT 113L - LOW

Small block Chevy, Short water pump  
Driver's side - wide mount.



\*NOTE: Exhaust Spacers- with HEADERS- use the 2 1/4" long x 5/8" O. D. Spacers. With RAMS HORN MANIFOLDS use the 1/4" long x 3/4" O. D. Spacer at rear hole of bracket and a 1 1/16" long x 3/4" O. D. Spacer at front hole of bracket. With the later DROP-TYPE manifolds use the 1 1/16" long x 3/4" O. D. spacers at both bracket holes. As with any mount system, assemble all of the brackets to engine BEFORE TIGHTENING THE BOLTS.

We use a belt length of 60-61" with this mount on installations in our shop. However; this can vary with the diameter of your pulleys.

**As with any part of this nature, make sure it fits your application before painting or plating. Parts that have been painted, plated, or modified may not be returned.**

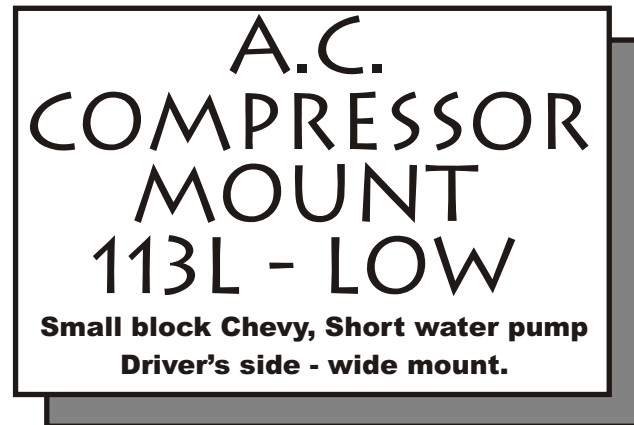

**ALAN GROVE COMPONENTS, INC.**  
**27070 METCALF ROAD**  
**LOUISBURG, KS 66053**