

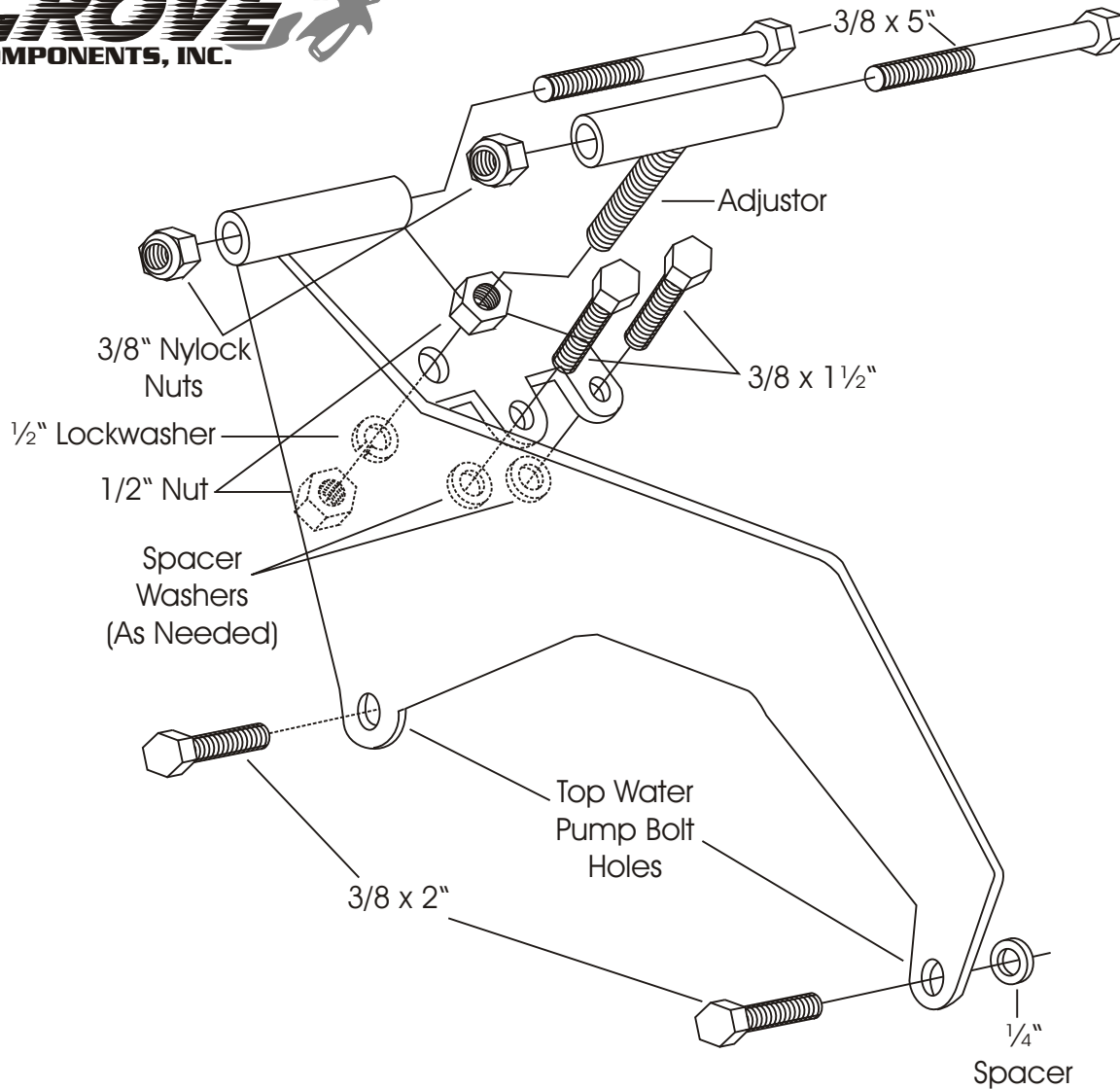

# A.C. COMPRESSOR MOUNT 100R

Small Block Chevy - Short Water Pump  
Passenger Side



Note:

Install bolts into the water pump first. Then determine the number of spacer washers needed between the bracket and intake manifold. This will vary with the thickness of the various brands of manifolds. **START ALL MOUNTING BOLTS BEFORE TIGHTENING.**

We use a belt length of 54 to 55" with this mount on installations in our shop. However; this can vary with the diameter of your pulleys.

**As with any part of this nature, make sure it fits your application before painting or plating. Parts that have been painted, plated, or modified may not be returned.**

A.C.  
COMPRESSOR  
MOUNT  
100R

Small Block Chevy - Short Water Pump  
Passenger Side

**ALAN GROVE COMPONENTS, INC.**  
**27070 METCALF ROAD**  
**LOUISBURG, KS 66053**