

R



Electric Milk Frother

USER CARE AND INSTRUCTION MANUAL

Thank you for purchasing the **RICARDO** electric milk frother. Before using this product, please read the user care and instruction manual carefully.

IMPORTANT SAFEGUARDS

.....

When using electrical appliances, basic safety precautions should always be followed to prevent fire, electric shock, serious personal injury and/or property damage, including the following.

READ ALL INSTRUCTIONS CAREFULLY BEFORE FIRST USE.

- ::: This appliance is not a toy and should not be used by children. Keep appliance and its cord out of the reach of children and pets. Close adult supervision is necessary when any appliance is used near children.
- ::: Always place the appliance on a flat, stable and heat-resistant surface. Do not use the appliance on temperature sensitive surfaces.
- ::: Do not place the appliance on or near a hot gas or electric burner or in a heated oven or microwave oven.
- ::: Keep away from curtains, wall coverings, clothing, dish towels or other flammable materials. Ensure there is sufficient space surrounding the appliance.
- ::: This appliance is intended for household use only. Do not use outdoors.
- ::: Do not operate the milk frother if empty.
- ::: This appliance should only be used to heat and froth milk or water for cleaning. Never use with other liquids or food.
- ::: Do not use the appliance for anything other than its intended use. Do not use attachments or accessories that are not recommended or sold by the manufacturer.
- ::: If this appliance begins to malfunction during operation, immediately unplug the cord from the outlet.
- ::: **CAUTION** Burn hazard! The appliance becomes hot during use. Do not touch hot surfaces. Always use the cool touch handle.
- ::: Do not fill the milk frother over the maximum fill lines. If the milk frother is overfilled, hot milk may spill
- ::: Scalding may occur if the lid is opened during the heating cycle. Always ensure the lid is securely closed during operation.
- ::: Always pour hot milk slowly and carefully as hot milk may cause burns or injuries.
- ::: Do not let the power cord hang (over the edge of a table or counter) to avoid tripping. Do not let the power cord touch hot surfaces.
- ::: Do not operate the appliance with a damaged cord or plug, after the appliance malfunctions or has been damaged in any manner. Do not attempt to repair this product yourself. If there is a problem, please call 1-866-226-9222.

- ::: To protect against electrical shock, never immerse the appliance, the power base, the power cord or the plug in water or other liquid.
- ::: Do not plug or unplug the product into/from the electrical outlet with wet hands.
- ::: Use the provided plug only.
- ::: Connect the power plug to an easily accessible outlet so that the appliance can be unplugged immediately in the event of an emergency.
- ::: The cord for this appliance should be plugged into a 120 V AC electrical wall outlet.
- ::: Do not leave the appliance unattended. Always make sure the motor has stopped completely, and the appliance is unplugged from the electrical outlet before cleaning or when not in use. To unplug, grasp the plug and pull it from the electrical outlet. Never pull the cord.
- ::: The device must not be operated via an external timer or remote control.

SAVE THESE INSTRUCTIONS - FOR HOUSEHOLD USE ONLY

NOTES ON THE PLUG

.....

For safety reasons, this appliance has a polarized plug (one blade is wider than the other). To reduce the risk of electric shock, this plug can only be inserted one way into the electrical outlet. If the plug does not fit correctly into the outlet, reverse the plug and insert into the outlet. If it still does not fit, contact a qualified electrician for further assistance. Do not attempt to modify the plug in any way.

NOTES ON THE CORD

.....

A short power-supply cord is provided to reduce risks resulting from becoming entangled in or tripping over a longer cord. Longer extension cords are available and may be used if care is exercised in their use.

IF AN EXTENSION CORD IS USED:

- ::: The marked electrical rating of the extension cord should be at least as great as the electrical rating of the appliance.
- ::: If the appliance is of the grounded type, the extension cord should be a grounding type 3-wire cord.
- ::: The longer cord should be arranged so that it will not drape over a countertop or tabletop where it can be pulled on.

ELECTRIC POWER

.....

If the electrical circuit is overloaded with other appliances, the appliance may not operate properly. It should be plugged into a separate electrical circuit.

TECHNICAL DATA

.....

Main voltage: 120 V / Frequency: 60 Hz / Power consumption: 500 watts

PARTS IDENTIFICATION

.....

Product may vary slightly from diagram.

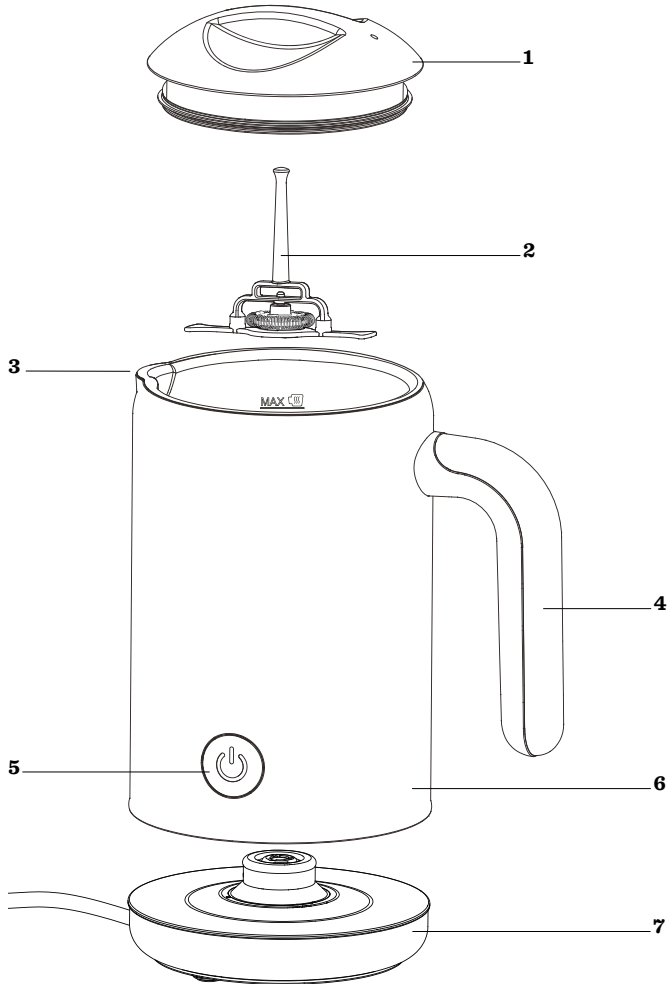

- 1.** clear lid
- 2.** magnetic whisk
- 3.** pouring spout
- 4.** cool touch handle
- 5.** power button
- 6.** body
- 7.** 360° swivel base

FILL LINES

.....

The milk frother has 3 fill lines.



..... Maximum capacity for heating milk: 350ml milk



..... Maximum capacity for frothing milk: 150ml milk



..... Minimum capacity for heating and frothing milk

CAUTION: Always fill the milk frother between the minimum (MIN) and the maximum (MAX) fill lines. Filling past the MAX lines may result in serious burns or injuries as hot milk may overflow. Filling below the MIN line may damage the appliance.

BEFORE FIRST USE

.....

- 1- Read all instructions and important safeguards.
- 2- Remove all packaging materials and ensure that all items have been received in good condition.
- 3- Tear up all plastic bags as they can pose a risk to children.
- 4- Do not plug the appliance into an electrical outlet before it is ready to be used.
- 5- Wipe the power base and the interior and exterior of the appliance with a soft damp cloth. Dry thoroughly. Hand wash the whisk. NEVER IMMERSE the appliance, the power base, the power cord, or the power plug in water or any liquid.
- 6- It is recommended to clean the milk frother before first use. Fill with water to the top line **MAX**  and press the power button twice continuously. The power button will light red. The milk frother will turn off automatically. Discard water and repeat 2-3 times.

NOTE

- ::: Do not use abrasive cleaners or scouring pads or any other object that could scratch.
- ::: Do not wash the exterior of the milk frother under running water.

USING THE MILK FROTHER

.....

During first use of the appliance, smoke and/or a slight odour may occur from the appliance because of the initial warming process of the materials. This is normal and will quickly disappear. It will not recur after appliance has been used a few more times.

- 1- Place the power base on a flat, dry, stable and heat-resistant surface.
- 2- Remove the lid and put the whisk into the milk frother.
- 3- Fill the milk frother with cold fresh milk, ensuring it is filled between the minimum (MIN) and maximum (MAX) lines. Refer to the "FILL LINES" section.
- 4- Close the lid securely and place the milk frother on the power base.
- 5- Plug the power cord into a 120 V AC wall outlet.
- 6- Press the power button to select one of the 3 frothing/heating functions.

::: **HOT FROTH:** Press the power button once. The power button blinks red. The appliance starts to froth and heat milk.

::: **COLD FROTH:** Press the power button for approximately 3 seconds. The power button blinks blue. The appliance starts to froth cold milk.

::: **HOT MILK:** Press the power button twice continuously. The power button lights up red. The appliance starts to heat and stir milk.

- 7- The milk frother will turn off automatically when the preset temperature is reached.
- 8- Lift the milk frother from the power base and open the lid to pour milk.
- 9- Unplug the appliance.

CAUTION:

- ::: When filling the milk frother, always remove it from the power base.
- ::: Operate carefully when pouring the milk from the milk frother as hot milk may result in severe burns.
- ::: The appliance can be turned off anytime during use by pressing the power button or lifting the milk frother from the base.
- ::: After each use, please wait 2 minutes to allow the thermostat to rest. After 2 minutes the milk frother can be used again.

HELPFUL TIPS

- ::: Both dairy and non-dairy milk can be used in the frother. The different protein content in milks will affect the appearance of the froth. For optimal froth, use whole or semi skimmed milk at refrigerated temperature (about 4-6 °C). Milk which has been frozen will not froth.
- ::: For hot chocolate, add the desired amount of chocolate powder or small chocolate shavings directly into the milk frother with the milk and follow the instructions for **HOT MILK**.

CLEANING

.....
IMPORTANT: Unplug the appliance and allow all parts to cool down completely before handling or attempting to clean.

- ::: DO NOT IMMERSE the appliance, the power base, the power cord or the power plug in water or any liquid nor allow moisture to come in contact with these parts. Always ensure that the power base is kept dry.
- ::: After each use, empty the milk frother. Remove and hand-wash the whisk. Rinse the interior of the milk frother with warm water and wipe it with a soft cloth.
- ::: If needed, wipe the power base and the exterior of the milk frother with a soft damp cloth. Dry thoroughly. Do not wash the exterior under running water.

NOTE: Do not use abrasive cleaners or scouring pads or any other object that can scratch the surface

STORAGE

.....

Ensure all pieces are clean and dry before storing. Store appliance in a dry, clean place. Never wrap the cord tightly as this could place undue stress on the cord where it connects to the appliance, causing it to fray and break. Keep it loosely coiled.

2-YEAR LIMITED WARRANTY

.....

This warranty covers any defects in materials and workmanship for a period of two (2) years from the date of the original purchase. Please retain your original receipt as a proof of the purchase date. Any complaints must be registered within the warranty period. The product will be repaired, replaced (parts or entire appliance) or refunded at our sole discretion. Shipping charges may apply.

This warranty does not cover normal wear of parts or damage resulting from any of the following: negligent use or misuse of the product including failure to clean the product regularly, use for commercial purposes, accident, use on improper voltage or current, use contrary to the operating instructions, disassembly, repair or alteration by anyone other than a **RICARDO** authorized service agent. Stains, discoloration and minor scratches on the inside and outside of the appliance constitute normal use, do not affect performance and are not covered by this warranty.

For assistance or general information regarding this product and the warranty, please contact our customer service:

::: by e-mail: kitchenproducts@ricardocuisine.com

::: by phone: 1-866-226-9222