

-PHANTOM BACK by FUTURE MOBILITY

PHANTOM BACK



The **Phantom Back™** is made specifically for the most active wheelchair users. Individuals who require back support, and need the freedom of unrestricted upper body movement. Custom built to fit rigid wheelchair frames and replace standard back support technology. This model offers maximum seat-to-back angle adjustment within the ideal range.

A well-designed back support panel and cushion promote posture support in the pelvic region, which is needed for fatigue reduction. Accessibility, ease of adjustment, and a light weight make the Phantom Back™ your model of choice for supporting an active wheelchair user

Phantom Series STYLE: Phantom Back Backs

Stock Sizes – Same Day Shipment

ADP CODE: **SEBFM0070**

Part Number	Size W x H
PB127	12" x 7"
PB137	13" x 7"
PB147	14" x 7"
PB157	15" x 7"
PB167	16" x 7"

Lateral Dimensions - Phantom

PHANTOM, Heights 14, 16, 18, 20

Chair Width	DIM B (")	DIM A (")
12"	9.5	1.4
13"	10.5	1.4
14"	11.5	1.4
15"	12.5	1.4
16"	13.5	1.4
17"	14.5	1.4
18"	15.5	1.4



Cover, Foam Layers and
Aluminum Hardware

PRODUCT HIGHLIGHTS

Height Adjustments
Infinite adjustment along wheelchair posts. Hardware and slotted holes in the back panel provide 3" adjustment range increments of 1", to overcome cross brace obstacle on the wheelchair posts.

Angle Adjustments
In relation to the wheelchair back support posts, the hardware accommodates up to 15 degrees anterior and up to 15 degrees of posterior infinite angle adjustment within this range.

Wheelchair Posts Interface
Standard clamp hardware will properly fit 1" tubing diameter. For wheelchairs with 7/8" or 3/4" tubing diameter, insert spacers are included in the hardware.

Space for Storage
Pocket provided on back for storage of personal items.

Width Adjustments
Hardware allows width adjustment range of 3/4". For example 16" wide back would fit a wheelchair frame from 15-3/4" to 16-1/2".

Seat Depth Adjustments
Optimal seat depth of 1-1/4" behind wheelchair posts available with standard posts. Maximum seat depth is 2-1/2" behind the wheelchair posts, when anterior back angle is 15 degrees; minimum seat depth is 0" behind the wheelchair posts, when posterior angle is set to 15 degrees. For shorter seat depth than 0", a custom spacer is available to set the seat depth up to 2" in front of wheelchair posts.

Product Weight: 2.5 lbs (16"W x 7"H)
User Weight: 250 lbs
Warranty: 3 years limited on back, 90 days on cover, and 1 year on hardware

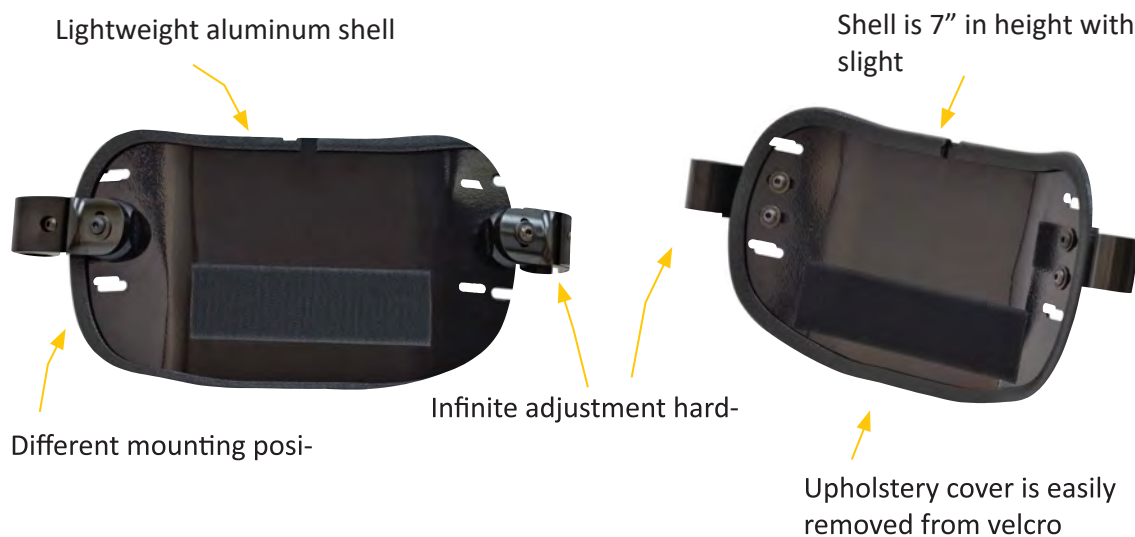

Phantom back shell

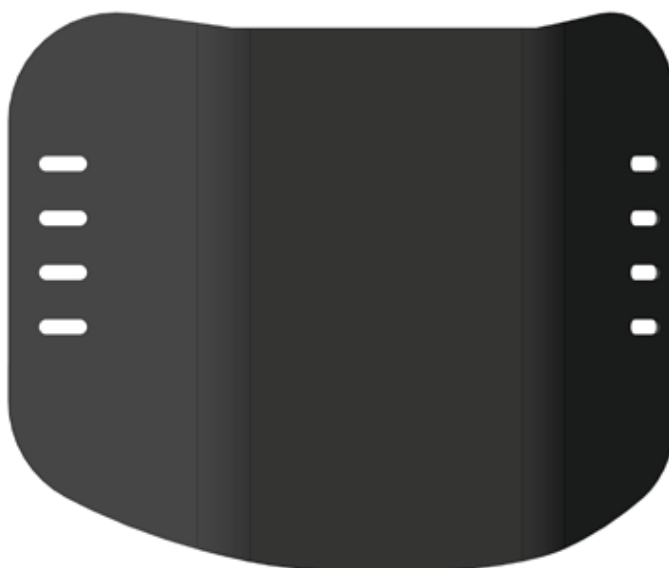



FUTURE MOBILITY

CANADA

6750 Professional Court, Mississauga,
Ontario, L4V 1X6, Canada



1-888-737-4011



www.futuremobility.ca



USA



1 Buffalo River Place, Buffalo,
NY, 14210, U.S.A.



1-855-938-8873



www.futuremobility.com



FUTURE MOBILITY