

| STROBE FLASH TUBES | | | | | |
|---------------------------------|---------|--|---------------|--|--|
| Part Numbers | Voltage | Power Consumption | Base | | |
| XN000 8GS 910 369-001 | 12-72V | - | Circuit Board | | |
| Note | | For use only with appropriate electronic control gear. Suits Firebolt Plus Series Strobe Lamps. | | | |

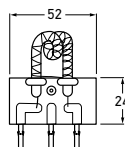

P/N XN000



| | | | | | |
|---------------------------------|--------|---|---------------|--|--|
| XN451 8GS 910 368-001 | 12-48V | - | Circuit Board | | |
| Note | | For use only with appropriate electronic control gear. Suits 451 Series Strobe Lamps | | | |

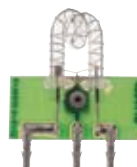

P/N XN451

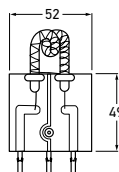

| | | | | | |
|---------------------------------|--------|---|---------------|--|--|
| XN551 8GS 910 362-001 | 12-48V | - | Circuit Board | | |
| Note | | For use only with appropriate electronic control gear. Suits Pulsator 551 Series Strobe Lamps. | | | |



P/N XN551

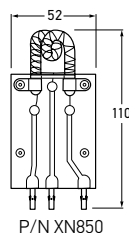

P/N XN850

| STROBE FLASH TUBES | | | | | |
|----------------------------------|---------|---|---------------|--|--|
| Part Numbers | Voltage | Power Consumption | Base | | |
| XN850 8GS 910 366-001 | 12/48V | - | Circuit Board | | |
| Note | | For use only with appropriate electronic control gear. Suits 851 Series Strobe Lamps. | | | |
| XN6750 8GS 910 370-001 | 12/24V | - | Circuit Board | | |
| Note | | For use only with appropriate electronic control gear. Suits 6750 Series Strobe Lamps. | | | |

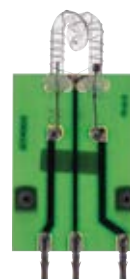

P/N XN850



P/N XN6750