

Numéro de l'article:

0834-48E

SKU:

0834-48E

MMOBICO INC



1



2



3

Base

1. Thread 4 cam pins into the white pre-inserted nuts of the bottom board.
2. Thread 6 cam pins into the white pre-inserted nuts of each of the 2 side boards.
3. Install the front panel onto the bottom board by securing the 2 cam locks.

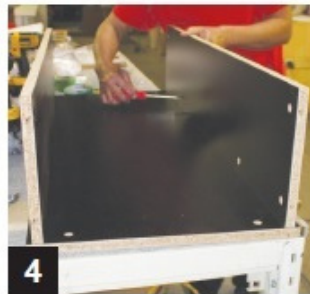

4

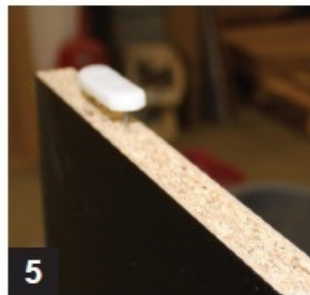

5



6b

Base & Main

4. Install the back panel onto the bottom board by securing 2 cam locks
5. Use a mallet to tap on the plastic glides.
6. Place one of the side boards on the floor and position the base construction over the cam pins. Be sure to align the groove in the sideboard to the groove in the base (6a). Secure them together with 6 cam locks (6b).



6a



7



8



9



10

Main

7. Slide glass panel within groove channel.
8. Place the other sideboard on the unit by aligning the groove with the glass.
9. Secure the panel by tightening the 6 cam locks.
10. What the display resembles at this stage.

Numéro de l'article:

0834-48E

SKU:

0834-48E

MMOBICO INC

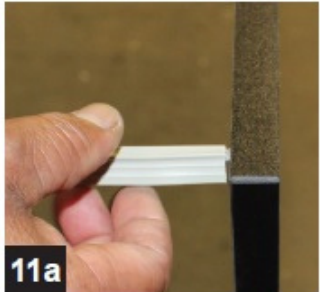

11a

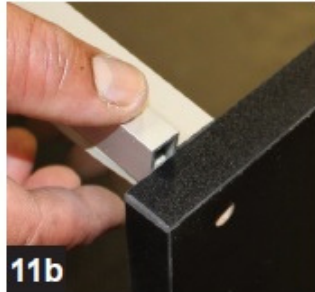

11b



14

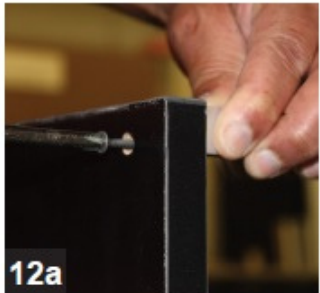

12a



12b

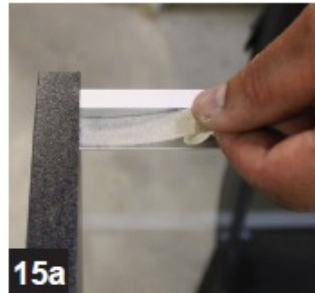

15a

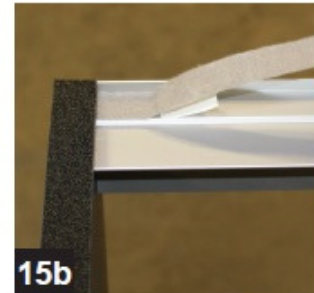

15b

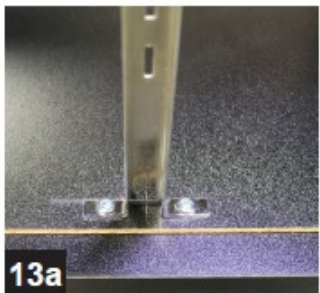

13a

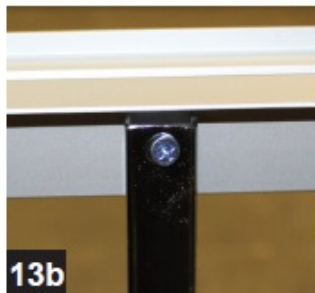

13b



16



17



18



Main

11. Press the glass trim seal against the top edge of the glass (11a). Press fit the front trim against the glass trim seal (11b).

12. Secure the front aluminum profile with 1 screw on each side (12a). Secure the back aluminum profile with 2 screws on each side (12b).

13. Align the shelf rail brackets with the pre-drilled holes and secure with 2 screws on the base and 1 through the back aluminum profile.

Main

14. Press fit the door track into the channel in the back of the bottom board.

15. Apply the felt strip tape along the length of the front aluminum profile (15a) and the length of the back aluminum profile (15b).

16. Arrange shelf brackets to desired location and using a mallet, gently tap them into place. Gently place glass shelves and glass top into position.

17. Press fit the hole plugs on the exterior of the unit.

Doors

18. Place the door panels on the track by sliding the panel into the upper channel and setting it down on the lower track.